

We are committed to the continuous development and production of medical devices suitable for minimally invasive surgery.



Zhejiang Geyi Medical Instrument Co., Ltd. is a high-tech company integrating R & D, production, sales and service. It' s headquartered in Jiande, Hangzhou City. The company has established a research and development and production base of 20000 square meters in Jiande. It has a clean workshop of 5000 square meters and a laboratory of 500 square meters. The company has a sound quality management system and equipment with a high degree of automation of production processes and testing methods, the company has successfully passed the "Medical Device Production Quality Control", "Management Standard" system assessment, and obtained ISO13485 medical device quality management system certification; Its product series of disposable trocars, digital endoscopes, electrocoagulation surgical instrument , surgical stapler series, endoscopic image camera systems, medical equipment have obtained domestic registration certificates and EU CE certificates. camera systems, medical equipment have obtained domestic registration certificates and EU CE certificates.

In terms of minimally invasive surgical instrument products, the company has a research and development team with considerable research and development experience, and establish a long-term cooperative relationship with a number of well-known hospital clinical experts. The company commit to continuous research and development and production for more suitable medical products for minimally invasive surgery, which base on scientific and technological innovation, and the guidance of famous clinical experts and professors.

Up to now, the company has got more than 50 patents for core product inventions and utility models. Rely on excellent products quality, perfect after-sales service, unremitting efforts, independent research and development, the products have been marketed all over the world, contributed to human health care.

## Enterprise core values

---

Customer centered, employees oriented, high-quality products reflect the excellent personality of Geyi employees.

## Enterprise Mission

---

Provide high-quality medical devices for human beings, to make human beings healthier and a better life.

## Enterprise Vision

---

Build a century-old Geyi, make Geyi become the pride of Geyi people and the pride of society.

## Enterprise Spirit

---

Win in error correction ability . The stronger the error correction ability is, the excellent Geyi will be, keeping ahead of the competition.

## 1



### Disposable Trocars Series

- 1.1 Disposable Trocars . . . . . Page 2
- 1.2 Disposable Trocar for Thyroid Surgery . . . Page 5
- 1.3 Disposable Pediatric Trocar . . . . . Page 6
- 1.4 Disposable Trocar (Single Port) . . . . . Page 7
- 1.5 Disposable Single-port Trocar (Soft Sheath) . Page 8



## 2



### Disposable Digital Endoscopes Series

- 2.1 Single-use Digital Flexible Ureteroscope . . . Page 9
- 2.2 Single-use Digital Hysteroscope . . . . . Page 10
- 2.3 Single-use Digital Cystoscope . . . . . Page 11
- 2.4 Single-use Digital Bronchoscope . . . . . Page 12
- 2.5 Single-use Digital Choledochoscope . . . . . Page 13



## 3



### Equipment and Image Processor Series

- 3.1 Medical Endoscope Camera System(4K) . . . Page 14
- 3.2 Medical Endoscope Camera System (Dual Endoscopes) . . . . . Page 15
- 3.3 Image Processor . . . . . Page 16
- 3.4 Image Processor (Portable) . . . . . Page 17



## 4



### Disposable Electrocoagulation Surgical Instrument Series

- 4.1 Disposable Laparoscopic Monopolar Electrode(Cutting Electrode) . . . . . Page 18
- 4.2 Disposable Laparoscopic Monopolar Electrode(Dissector) . . . . . Page 19
- 4.3 Disposable Laparoscopic Monopolar Electrode(Grasper) . . . . . Page 20
- 4.4 Disposable Laparoscopic Monopolar Electrode(Scissor) . . . . . Page 21
- 4.5 Disposable Laparoscopic Bipolar Forceps . . . Page 22
- 4.6 Disposable Suction Irrigation With Electrode System . . . . . Page 23



## 5



### Disposable Surgical Stapler Series

- 5.1 Disposable Circumcision Staplers . . . . . Page 24
- 5.2 Disposable Linear Cutter Staplers . . . . . Page 25
- 5.3 Disposable Linear Cutter for Endoscope Use Page 26
- 5.4 Disposable Linear Staplers . . . . . Page 26
- 5.5 Disposable Circular Staplers for Hemorrhoids Page 27
- 5.6 Disposable Circular Staplers . . . . . Page 27



## 6



### Other Products Series

- 6.1 Disposable Suction & Irrigation Sets . . . . . Page 28
- 6.2 Disposable Specimen Retrieval Bag . . . . . Page 29
- 6.3 Disposable Veress Needle . . . . . Page 29
- 6.4 Disposable Automatic Clip Applier . . . . . Page 30
- 6.5 Ligating Clips . . . . . Page 31



## 7



### New Products Coming Soon

**1** Disposable Trocars Series

**1.1** Disposable Trocars

GYTR-I (Ordinary type)



①Cannula with stopcock

②Dilating tip obturator

③Complete set

Triple seal, air tight double safety.

Blunt tip, small trauma, fast recovery.

**Product features**

1. Various specifications of the trocars can meet different demands of surgery.
2. Triple seal, air tight double safety. Superior sealing performance, maintains clinical pneumoperitoneum.
3. Bladeless obturator, with two tiny flanks, it reduces the probability of puncture hole hernia.

GYTR-II (Stainless steel type)

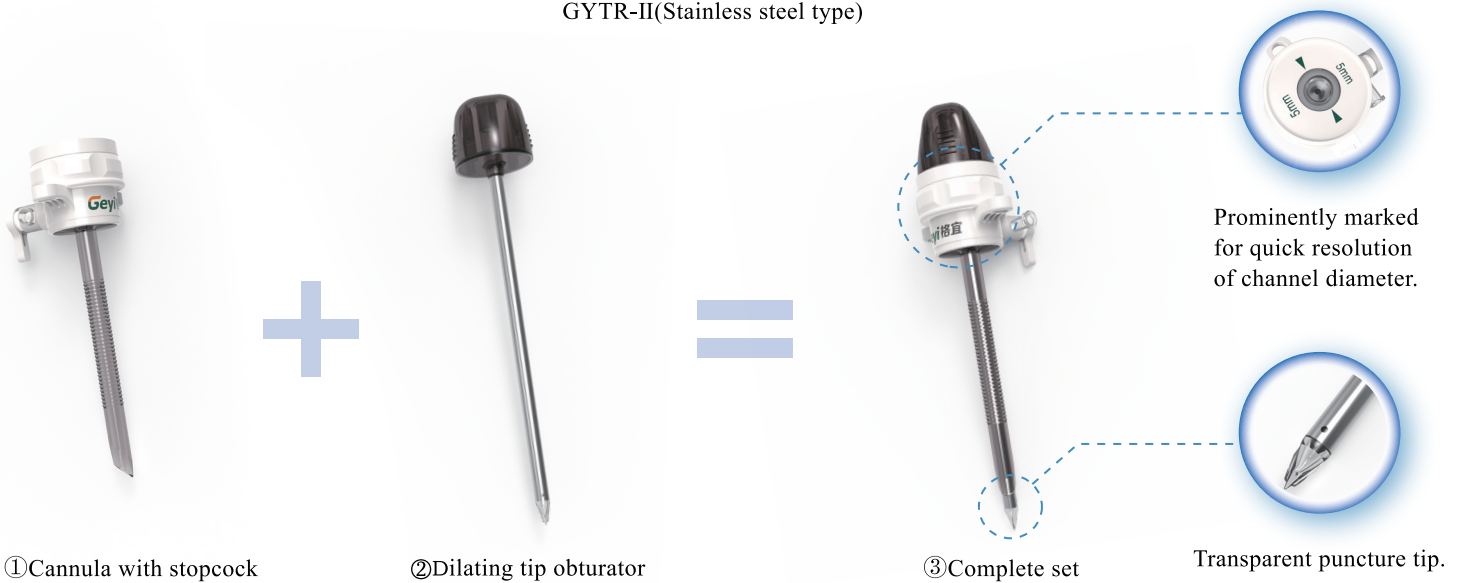

①Cannula with stopcock

②Dilating tip obturator

③Complete set

Prominently marked for quick resolution of channel diameter.

Transparent puncture tip.

**Product features**

1. Multiple sealing without conversion, which is convenient for the switching of surgical instruments of different specifications, and improves the operation efficiency.
2. Metal reinforcing trocar obturator, smooth tube, small resistance, not easy to bend, easy to puncture.

GYTR-III(Bladed type)



### Product features

1. Ergonomic design, comfortable operation.
2. The seal cover of 10~15mm trocars can be opened, allows to remove large tissue from the cannula.
3. Sharp blade in the obturator, no need for extra incision, easy to puncture, assures small wound and fast recovery.

GYTR-IV(Optical type)

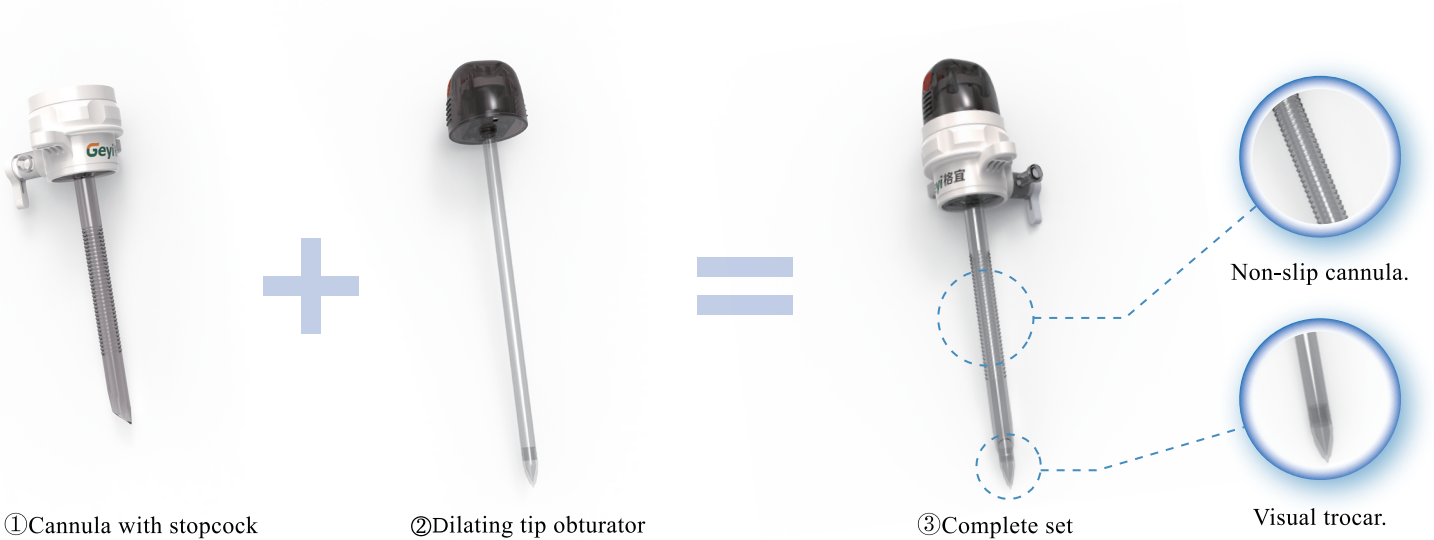

### Product features

1. Threaded cannula, increase the friction between the cannula and the abdominal wall, avoid the cannula falling off.
2. The transparent puncture obturator and its tip can realize visual puncture under the guidance of the laparoscope and avoid unnecessary injury caused by blind puncture.

## Assembly-single pack

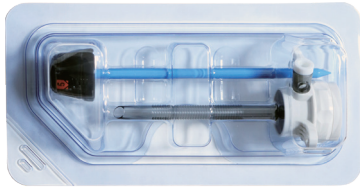

GYTR-I(Ordinary type)

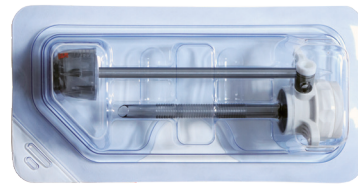

GYTR-II(Stainless steel type)

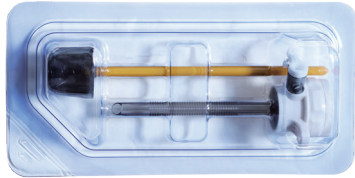

GYTR-III(Bladed type)

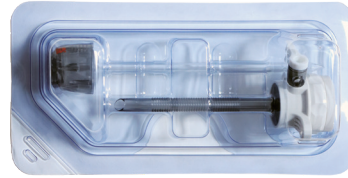

GYTR-IV(Optical type)

## Specifications

Model	Specification	Contents	Cannula Inner Diameter(mm)	Working length(mm)	Explanation
GYTR- I	Φ3	1pcs 3mm cannula with stopcock,1pc 3mm dilating tip obturator	Φ3.8	65	GYTR-III、IV not applicable
	Φ5	1pcs 5mm cannula with stopcock,1pc 5mm dilating tip obturator	Φ6.0	100	/
GYTR- II	Φ10	1pcs 10mm cannula with stopcock,1pc 10mm dilating tip obturator	Φ11	110	/
GYTR- III	Φ12	1pcs 12mm cannula with stopcock,1pc 12mm dilating tip obturator	Φ13	110	/
GYTR- IV	Φ15	1pcs 15mm cannula with stopcock,1pc 15mm dilating tip obturator	Φ16	110	GYTR-III、IV not applicable

## Assembly - kit pack



GYTR-II Kit A



GYTR-III Kit F



## Specifications

Model	Specification	Contents
GYTR- I GYTR- II GYTR- III GYTR- IV	Kit A	2pcs 5mm and 2pcs 10mm cannula with stopcock + 1pcs 5mm and 1pcs 10mm dilating tip obturator + 1pcs veress needle + 1pcs specimen bag
	Kit B	2pcs 5 mm and 1pcs 10mm cannula with stopcock + 1pcs 5mm 1pcs 10mm dilating tip obturator + 1pcs veress needle + 1pcs specimen bag
	Kit C	3pcs 5mm and 1pcs 10mm cannula with stopcock + 1pcs 5mm and 1pcs 10mm dilating tip obturator + 1pcs veress needle + 1pcs specimen bag
	Kit D	1pcs 3mm and 1pcs 5mm and 1pcs 10mm cannula with stopcock+1pcs 3mm and 1pcs 5mm and 1pcs 10mm dilating tip obturator+1pcs veress needle + 1pcs specimen bag
	Kit E	1pcs 5mm and 2pcs 10mm cannula with stopcock + 1pcs 5mm and 1pcs 10mm dilating tip obturator + 1pcs veress needle + 1pcs specimen bag
	Kit F	2pcs 5mm and 2pcs 12mm cannula with stopcock + 1pcs 5mm and 1pcs 12mm dilating tip obturator + 1pcs veress needle + 1pcs specimen bag
	Kit J	2pcs 5mm and 1pcs 10mm and 1pcs 12mm cannula with stopcock+1pcs 5mm and 1pcs 10mm dilating tip obturator+1pcs veress needle+1pcs specimen bag
	Kit K	2pcs 5mm cannula with stopcock+1pcs 5mm dilating tip obturator
	Kit L	2pcs 10mm cannula with stopcock+1pcs 10mm dilating tip obturator
	Kit M	2pcs 12mm cannula with stopcock+1pcs 12mm dilating tip obturator
	Kit AA	1pcs 5mm and 2pcs 12mm cannula with stopcock+1pcs 5mm and 1pcs 12mm dilating tip obturator+ 1pcs veress needle+1pcs specimen bag

**1 Disposable Trocars Series**

**1.2 Disposable Trocar for Thyroid Surgery**

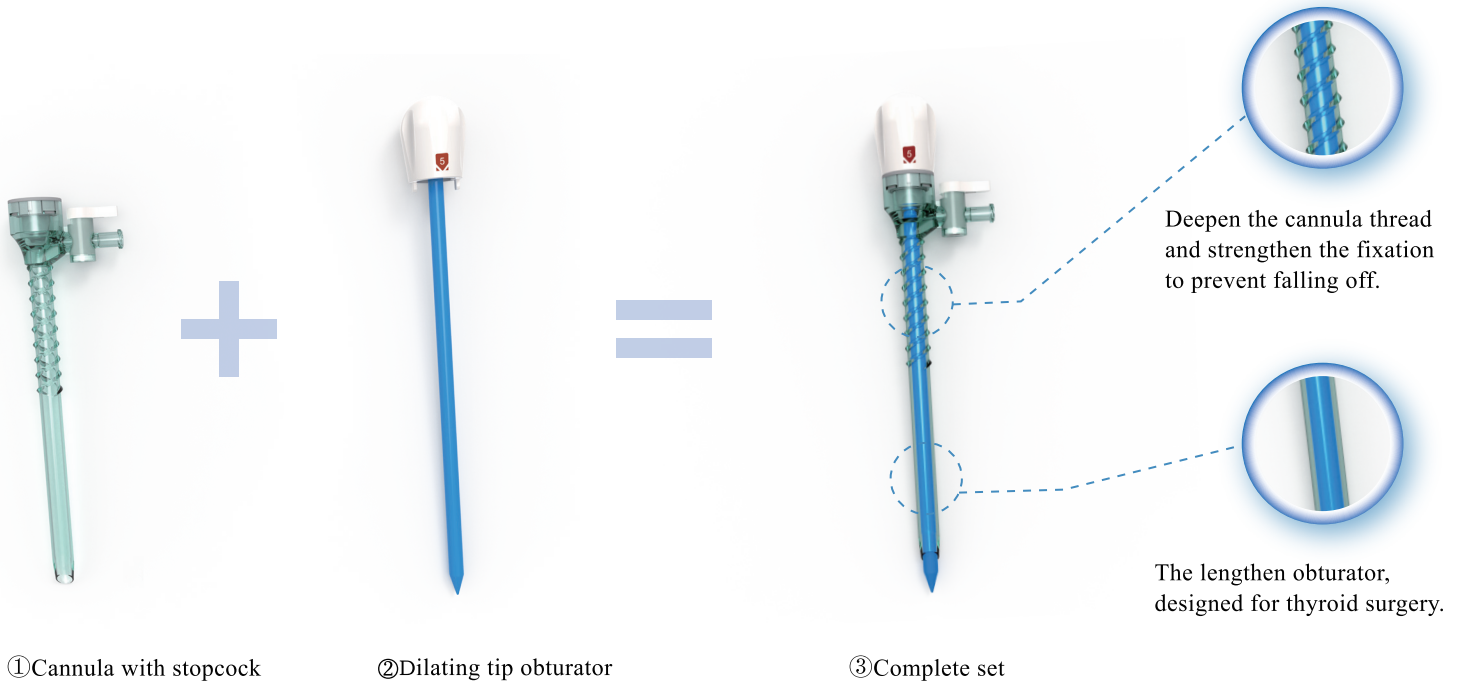

**Product features**

1. The lengthen obturator and deepen thread cannula help to strengthen fixation to prevent falling off.
2. Double-layer sealing design, less insertion force and dragging force, and reliable air tightness.
3. The lengthen obturator, designed for thyroid surgery.

Disposable trocar for thyroid surgery common specification table					
Model	Specification	Contents	Cannula Inner Diameter(mm)	Working length(mm)	Explanation
GYTR- I	Φ5JL	1pcs 5mmJL cannula with stopcock+ 1pcs 5mmJL dilating tip obturator	Φ6.0	Φ130	Thyroid surgery commonly used
	Φ10JL	1pcs 10mmJL cannula with stopcock+ 1pcs 10mmJL dilating tip obturator	Φ11.0	Φ130	
	Kit H1	2pcs 5mm and 2pcs 10mm cannula with stopcock+ 1pcs 5mm and 1pcs 10mm dilating tip obturator+ 1pcs veress needle + 1pcs specimen bag	/	/	

1.3 Disposable Pediatric Trocar

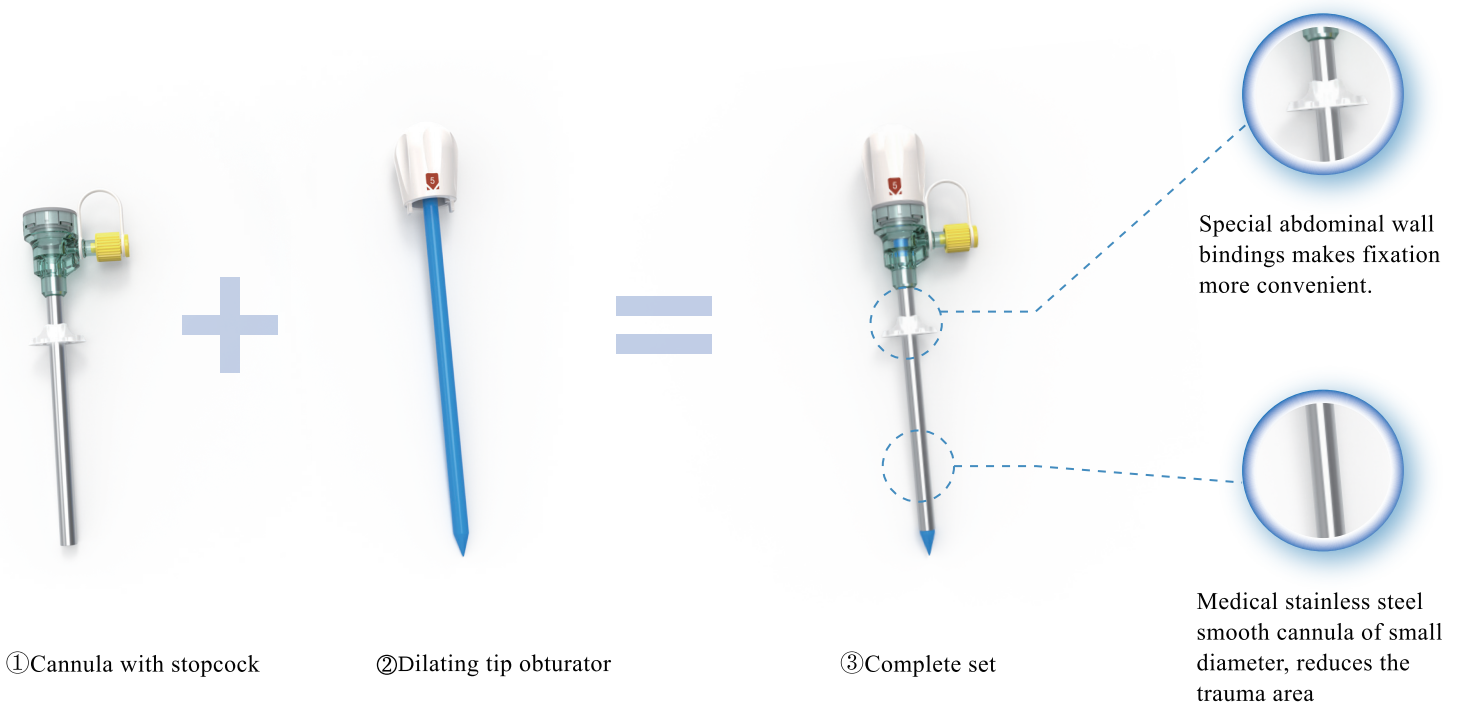

Product features

1. A specially designed abdominal wall retainer allows the cannula to be easily fixed in the desired position and prevents the cannula from sliding while the instrument enters and exits.
2. Medical stainless steel smooth cannula of small diameter, reduces the trauma area, and the probability of complications such as pore hernia.

Disposable Pediatric Trocar common specification table

Model	Specification	Contents	Cannula Inner Diameter(mm)	Working length(mm)	Explanation
GYTR-V	Φ3	1pcs 3mm cannula with stopcock, 1pc 3mm dilating tip obturator	Φ3.8	Φ60	Pediatric surgery commonly used
	Φ5	1pcs 5mm cannula with stopcock, 1pc 5mm dilating tip obturator	Φ6.0	Φ100	
	Kit Q	3pcs 5mm cannula with stopcock, 1pc 5mm dilating tip obturator	/	/	
	Kit V	2pcs 3mm and 1pcs 5mm cannula with stopcock + 1pcs 5mm dilating tip obturator + 1pcs veress needle + 1pcs specimen bag	/	/	

1.4 Disposable Trocar (Single Port)

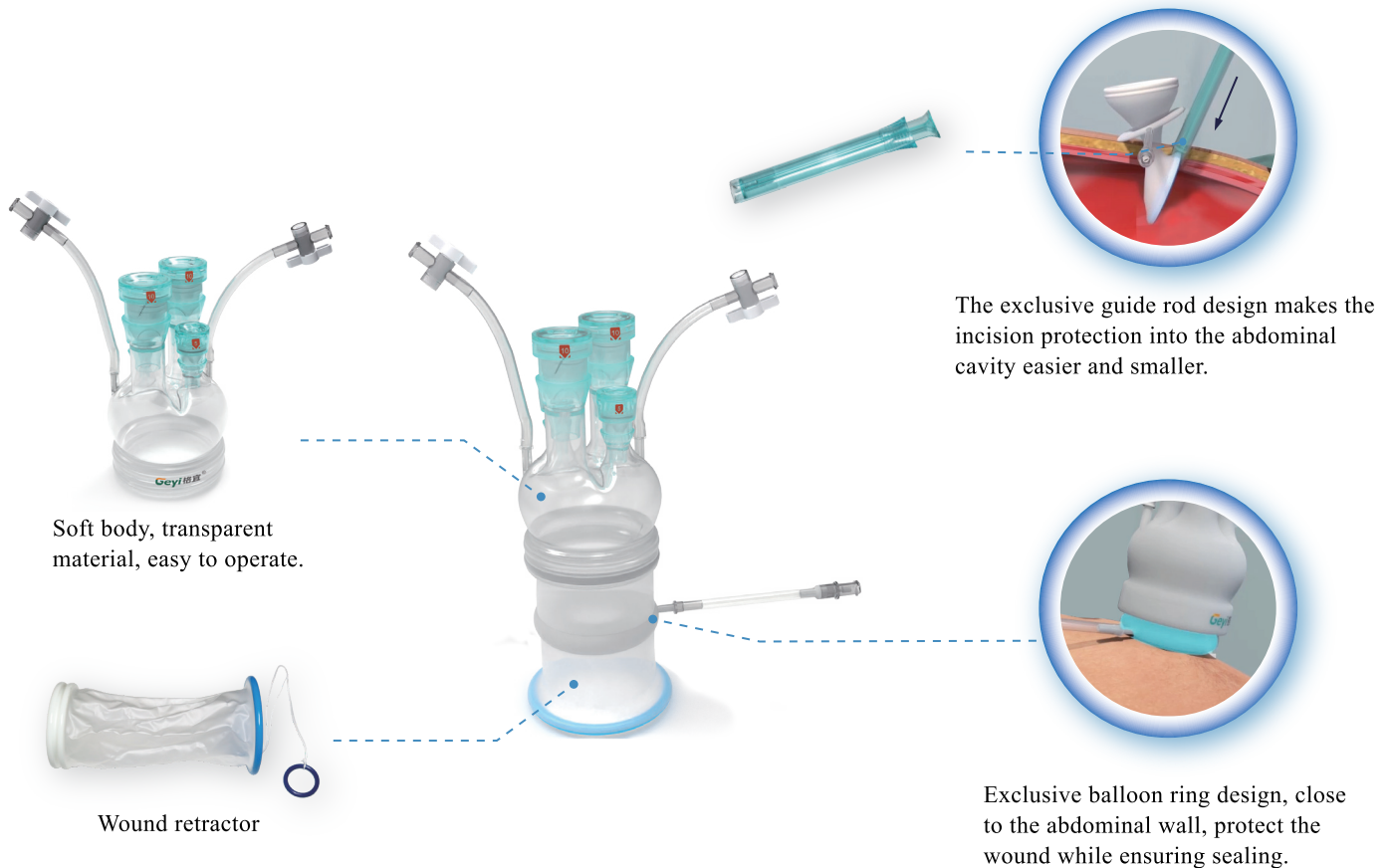

Product features

1. The membrane design of the product provides a larger operation space.
2. Exclusive balloon ring design for a more reliable seal and safer incision protection.
3. The exclusive guide rod design makes the incision protection into the abdominal cavity easier and smaller.
4. Fewer incisions during the operation, which is more minimally invasive and can recover quickly after the operation.

Disposable Trocar (Single Port) common specification table

Model	Diameter(mm)	Specification	Contents
GYTR-VII	Φ70	Kit J	(1pcs 5mm and 1pcs 10mm cannula with stopcock) 1pcs 70mm A sealed cap+ 1pcs balloon ring+1pcs guide rod
		Kit K	(2pcs 5mm and 1pcs 10mm cannula with stopcock) 1pcs 70mm B sealed cap+ 1pcs balloon ring+1pcs guide rod
		Kit L	(2pcs 5mm and 2pcs 10mm cannula with stopcock) 1pcs 70mm C sealed cap+ 1pcs balloon ring+1pcs guide rod
		Kit M	(2pcs 5mm and 1pcs 10mm and 1pcs with 12mm cannula with stopcock) 1pcs 70mm D sealed cap+1pcs balloon ring+1pcs guide rod
		Kit Q	(1pcs 5mm and 2pcs 10mm cannula with stopcock) 1pcs 70mm H sealed cap+ 1pcs balloon ring+1pcs guide rod
		Kit R	(1pcs 5mm and 2pcs 12mm cannula with stopcock) 1pcs 70mm I sealed cap+ 1pcs balloon ring+1pcs guide rod
	Φ90	Kit S	(1pcs 5mm and 1pcs 10mm cannula with stopcock) 1pcs 90mm A sealed cap+ 1pcs balloon ring+1pcs guide rod
		Kit T	(2pcs 5mm and 1pcs 10mm cannula with stopcock) 1pcs 90mm B sealed cap+ 1pcs balloon ring+1pcs guide rod
		Kit U	(2pcs 5mm and 2pcs 10mm cannula with stopcock) 1pcs 90mm C sealed cap+ 1pcs balloon ring+1pcs guide rod
		Kit V	(2pcs 5mm and 1pcs 10mm and 1pcs 12mm cannula with stopcock) 1pcs 90mm D sealed cap+1pcs balloon ring+1pcs guide rod
		Kit Z	(1pcs 5mm and 2pcs 10mm cannula with stopcock) 1pcs 90mm H sealed cap+ 1pcs balloon ring+1pcs guide rod
		Kit AA	(1pcs 5mm and 2pcs 12mm cannula with stopcock) 1pcs 90mm I sealed cap+ 1pcs balloon ring+1pcs guide rod

1.5 Disposable Single-port Trocar (Soft Sheath)

Product features

1. The membrane design of the product provides a larger operation space.
2. Exclusive balloon ring design for a more reliable seal and safer incision protection.
3. The exclusive guide rod design makes the incision protection into the abdominal cavity easier and smaller.
4. Fewer incisions during the operation, which is more minimally invasive and can recover quickly after the operation.
5. Variable height, fixed height incision wound retractor, and a variety of models are available to meet different clinical needs.
6. Detachable product, which is convenient for sampling during operation.

Disposable single-port trocar (soft sheath) common specification table	
Model	GYDK-A~S
Sealed cap outer diameter	Φ50、Φ70、Φ90、Φ110
Cannula length(mm)	70、90、170
Specification	Assembly
2A	1pcs 5mm+1pcs 10mm
2B	1pcs 5mm+1pcs 12mm
2C	2pcs 5mm
2D	1pcs 10mm+1pcs 12mm
2E	2pcs 10mm
2F	2pcs 12mm
3A	1pcs 5mm+2pcs 10mm
3B	1pcs 5mm+2pcs 12mm
3C	1pcs 5mm+1pcs 10mm+1pcs 12mm
3D	2pcs 5mm+1pcs 10mm
3E	2pcs 5mm+1pcs 12mm
3F	3pcs 5mm
3G	3pcs 10mm
3H	3pcs 12mm
4A	1pcs 5mm+2pcs 10mm+1pcs 12mm
4B	1pcs 5mm+1pcs 10mm+2pcs 12mm
4D	2pcs 5mm+2pcs 12mm
4E	2pcs 5mm+1pcs 10mm+1pcs 12mm
4F	3pcs 5mm+1pcs 10mm
4G	3pcs 5mm+1pcs 12mm
4H	3pcs 10mm+1pcs 12mm
4I	4pcs 5mm
4J	4pcs 10mm
4K	4pcs 10mm
5A	2pcs 5mm+1pcs 10mm+2pcs 12mm
5B	2pcs 5mm+2pcs 10mm+1pcs 12mm
5C	3pcs 5mm+1pcs 10mm+1pcs 12mm



Common Design



Soft body, transparent material, easy to operate.

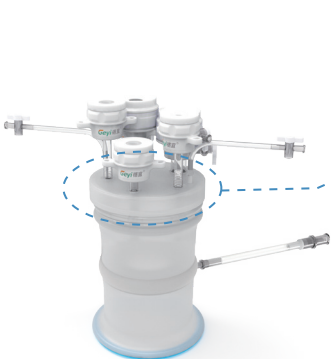

Platform Type



Silicone platform, can be inserted into the corresponding size of the cannula sheath.



It Is Suitable For Da Vinci Third Generation Si Robot



Independent 12 mm sheath for use with Da Vinci III Si robots.

2.1 Single-use Digital Flexible Ureteroscope

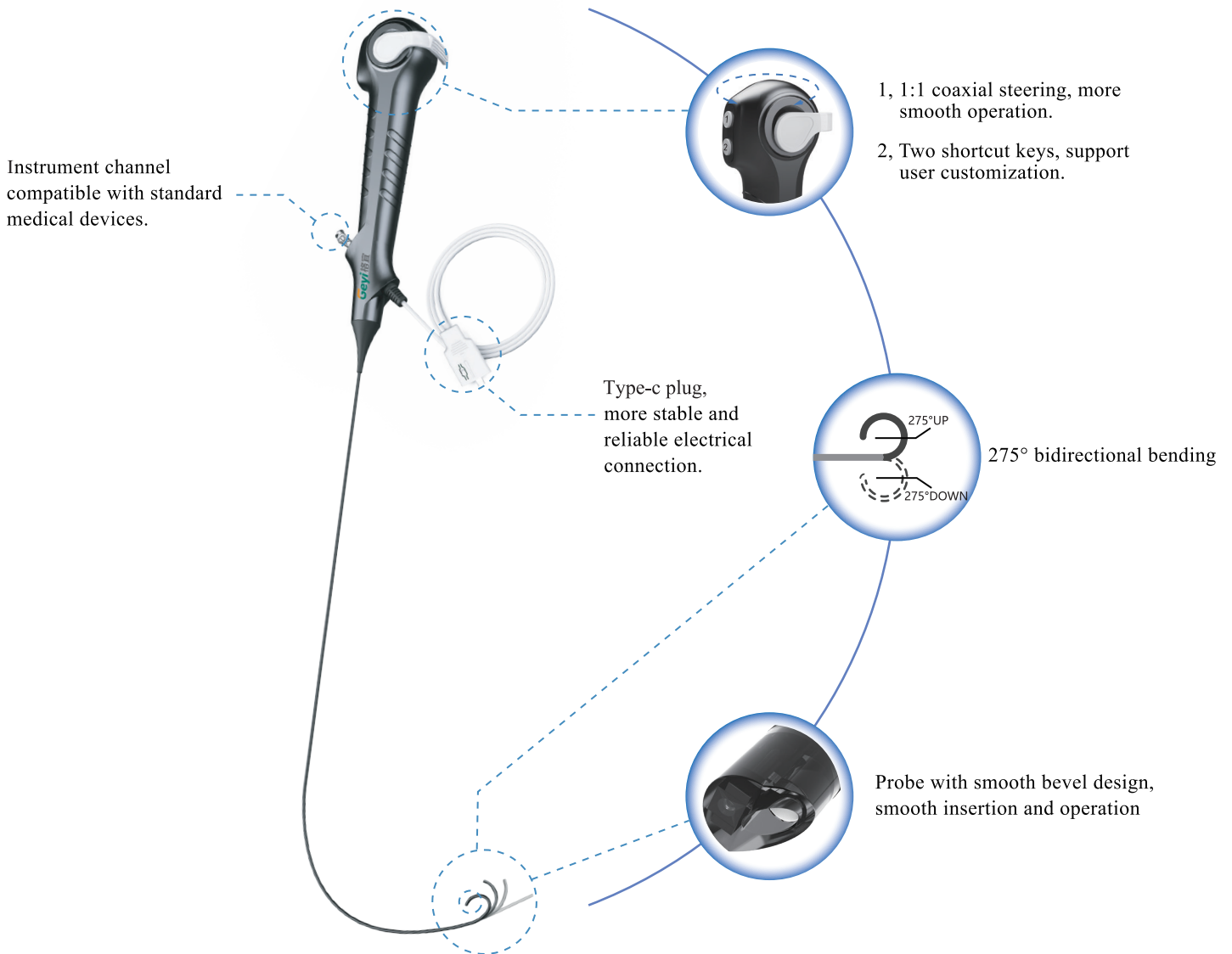

Product features

1. 275° bidirectional bending, 1:1 coaxial steering.
2. Handle keys can be preset with up to 15 functions.
3. Probe with smooth bevel design, smooth insertion and operation.
4. Front LED light source, High sensitivity CMOS, excellent color fidelity.
5. 160,000 pixel imaging.

Model	Max-insert Diameter(mm)	Bending angle	Working length(mm)	Working channel(mm)	Viewing angle	Depth of field (mm)
GY-UR9.3	9.3Fr(Φ3.1mm)	275°	670mm	3.6Fr(Φ1.2mm)	110°	3-50mm
GY-UR8.4	8.4Fr(Φ2.8mm)	275°	670mm	3.6Fr(Φ1.2mm)	110°	3-50mm
GY-UR7.5	7.5Fr(Φ2.5mm)	275°	670mm	3.4Fr(Φ1.1mm)	110°	3-50mm

2.2 Single-use Digital Hysteroscope

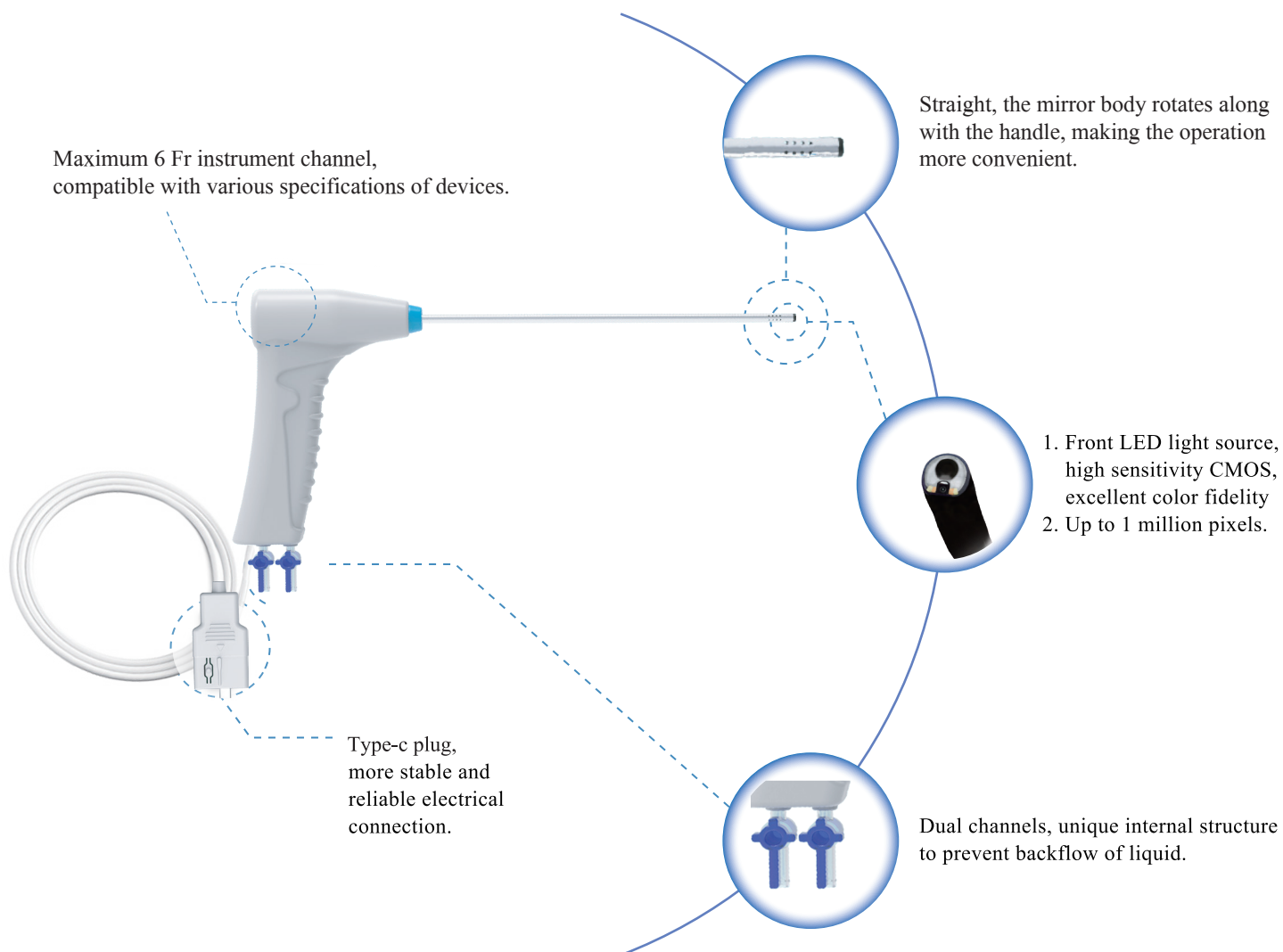

Product features

1. The tube diameter is thin, no need for uterus dilation, no need for anesthesia, less damage to the cervix.
2. 6 Fr instrument channel, and the compatibility of surgical instruments is wide.
3. Rapid dilation of the uterus, sustained and stable pressure.
4. Ergonomic grip handle design for dexterous and comfortable operation.

Model	Max-insert Diameter(mm)	Instrument Channel	Working length(mm)	Resolution	Viewing angle	Depth of field (mm)	Bending angle
GYUT-5.0-GY	15.6Fr(Φ5.2mm)	6Fr(Φ2.0mm)	200mm	1000,000 pixel	140°	3-100mm	0°

2.3 Single-use Digital Cystoscope

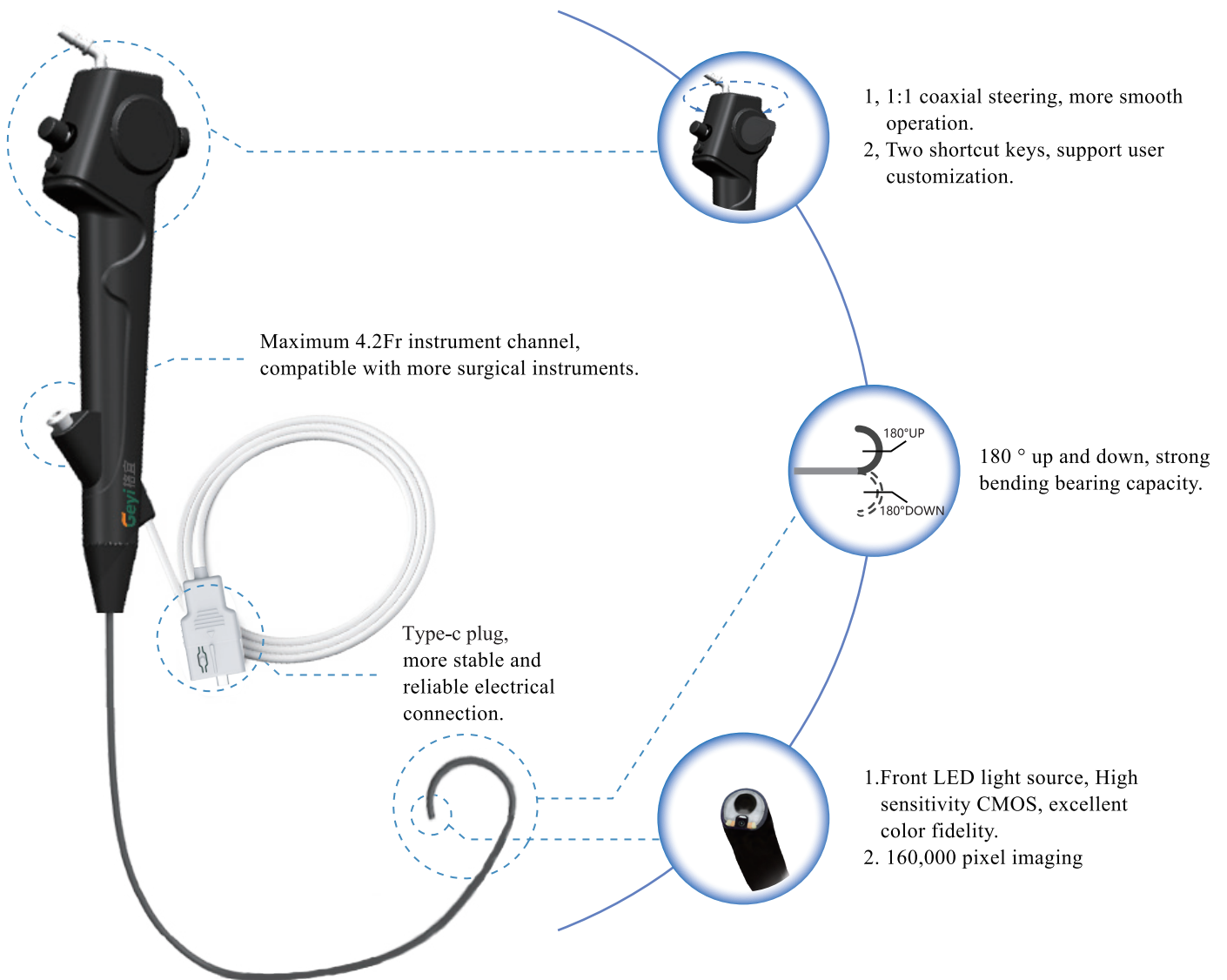

Product features

1. The diameter is small, no need for anesthesia, less damage for the tissue.
2. Maximum 4.2Fr instrument channel, compatible with more surgical instruments.
3. Ergonomic grip handle design for dexterous and comfortable operation.

Model	Max-insert Diameter(mm)	Instrument Channel	Resolution	Working length(mm)	Viewing angle	Depth of field (mm)	Bending angle
GYCY-4.8-GY	4.8(14.4Fr)	2.4-(7.2Fr)	160,000 pixel	380mm	120°	5-50mm	Up ≥ 180° Down ≥ 180°
GYCY-3.8-GY	3.8(11.4Fr)	1.4-(4.2Fr)	160,000 pixel	380mm	120°	5-50mm	Up ≥ 180° Down ≥ 180°

2.4 Single-use Digital Bronchoscope

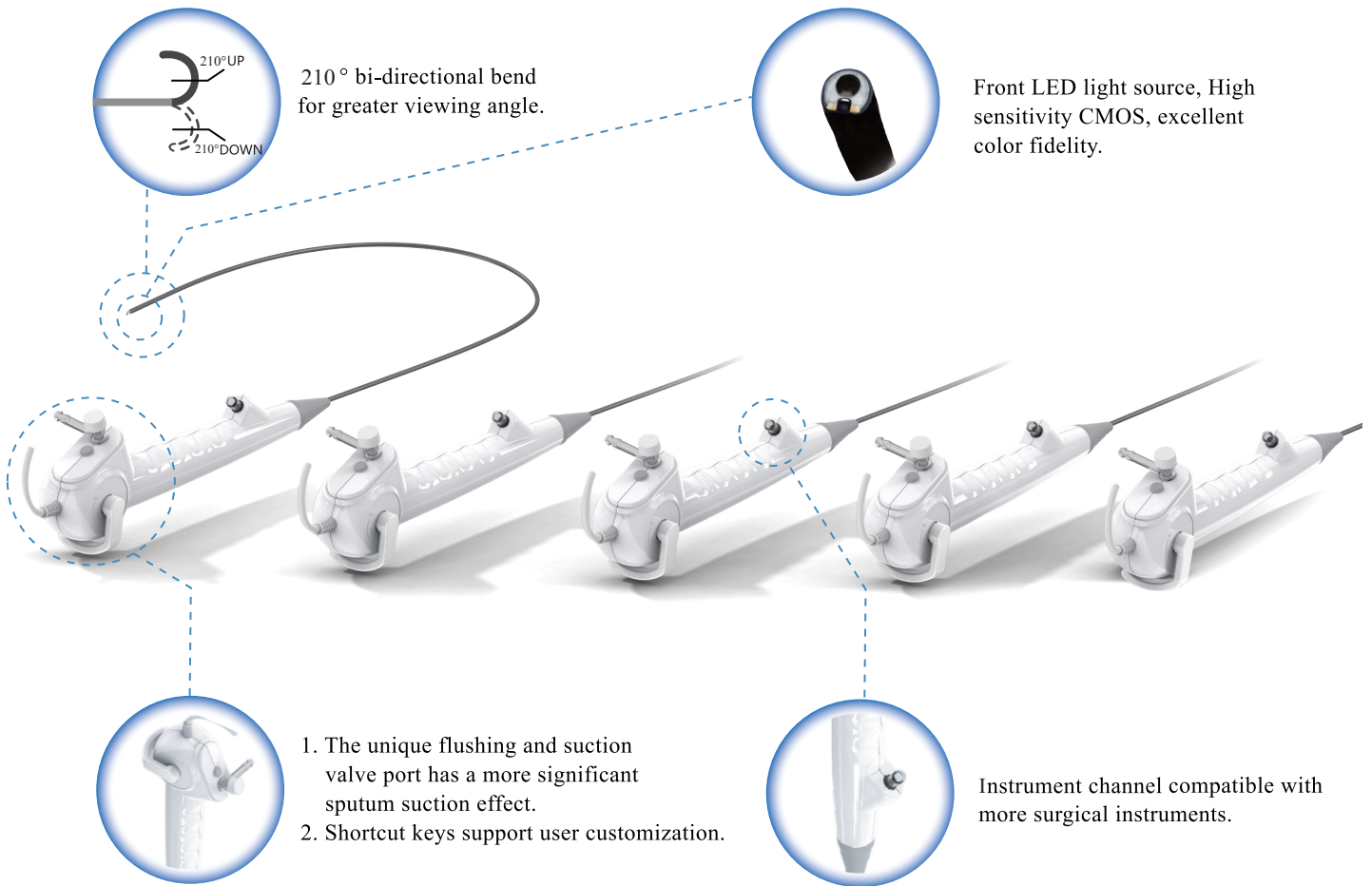

210° bi-directional bend for greater viewing angle.

Front LED light source, High sensitivity CMOS, excellent color fidelity.

1. The unique flushing and suction valve port has a more significant sputum suction effect.
2. Shortcut keys support user customization.

Instrument channel compatible with more surgical instruments.

Product features

1. When the flexible endoscope encounters resistance once enters the cavity, it can redistribute the pressure to adapt to the contour of the body cavity, bend passively and insert easily.
2. Bidirectional 210° bending angle and 210° wide field of view can facilitate observation and positioning and improve diagnostic efficiency.
3. The insertion part at the front end and the compact and simple operation part design can effectively reduce fatigue.
4. Excellent handling performance and easier exploration.

Model	Max-insert Diameter(mm)	Instrument Channel	Working length(mm)	Resolution	Viewing angle	Depth of field (mm)
GYBR-6.6-GY	19.8Fr(Φ6.6mm)	9.6Fr(Φ3.2mm)	600mm	1000,000 pixel	140°	3-50mm
GYBR-6.2-GY	18.6Fr(Φ6.2mm)	8.4Fr(Φ2.8mm)	600mm	1000,000 pixel	140°	3-50mm
GYBR-5.5-GY	16.5Fr(Φ5.5mm)	6.6Fr(Φ2.2mm)	600mm	1000,000 pixel	140°	3-50mm
GYBR-3.0-GY	9Fr(Φ3.0mm)	3.6Fr(Φ1.2mm)	600mm	160,000 pixel	120°	3-50mm
GYBR-2.0-GY	6Fr(Φ2.0mm)	0	600mm	160,000 pixel	120°	3-50mm

2.5 Single-use Digital Choledochoscope

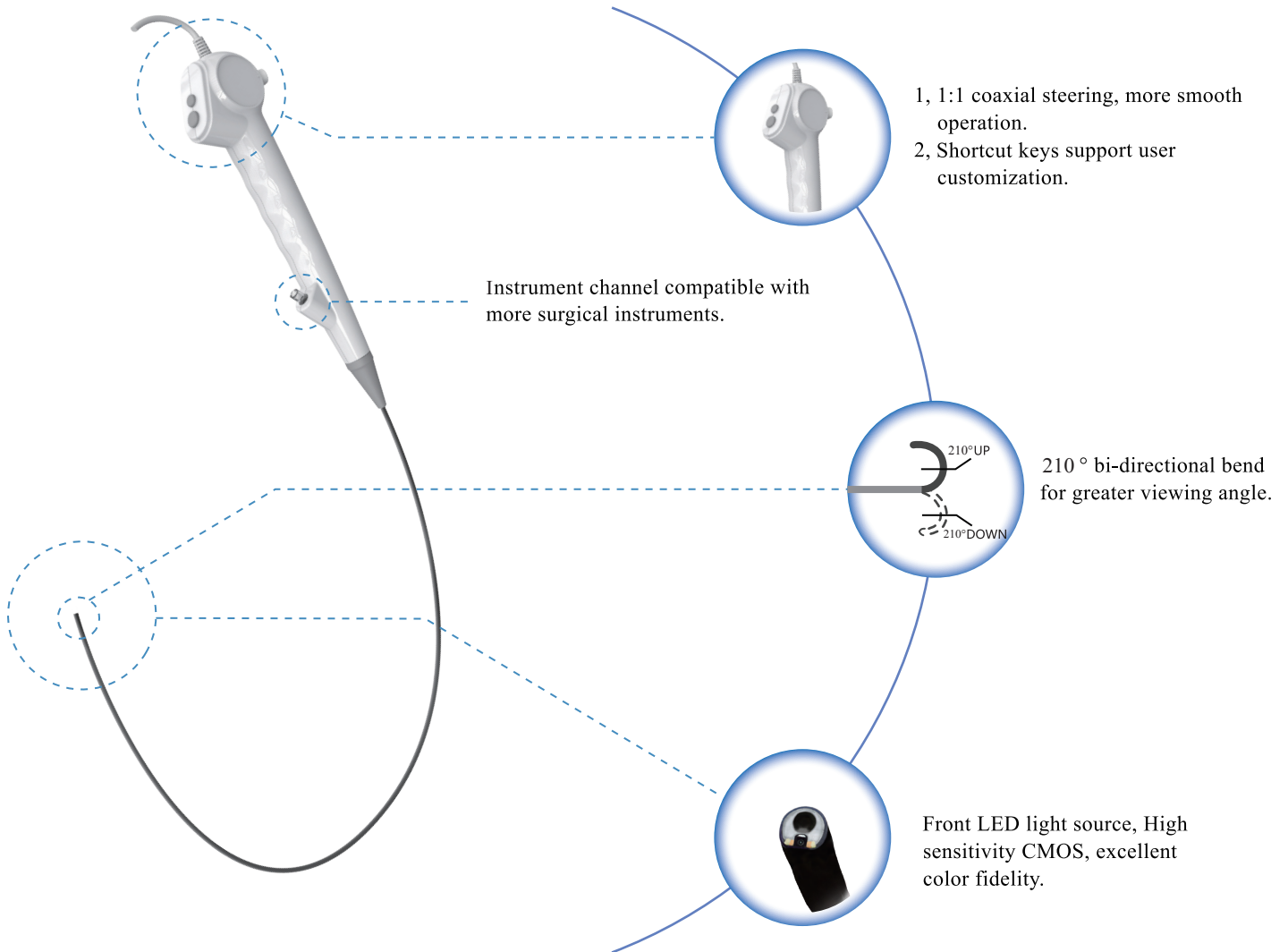

Product features

1. The diameter is small, no need for anesthesia, less damage for the tissue.
2. Instrument channel, compatible with more surgical instruments.
3. Ergonomic grip handle design for dexterous and comfortable operation.

Model	Max-insert Diameter(mm)	Instrument Channel	Working length(mm)	Resolution	Viewing angle	Depth of field (mm)
GYBI-5.3-GY	16Fr(Φ5.3mm)	6.6Fr(Φ2.2mm)	380mm	1000,000 pixel	140°	3-50mm
GYBI-4.3-GY	13Fr(Φ4.3mm)	6.6Fr(Φ2.2mm)	380mm	160,000 pixel	120°	3-50mm

## 3.1 Medical Endoscope Camera System(4K)

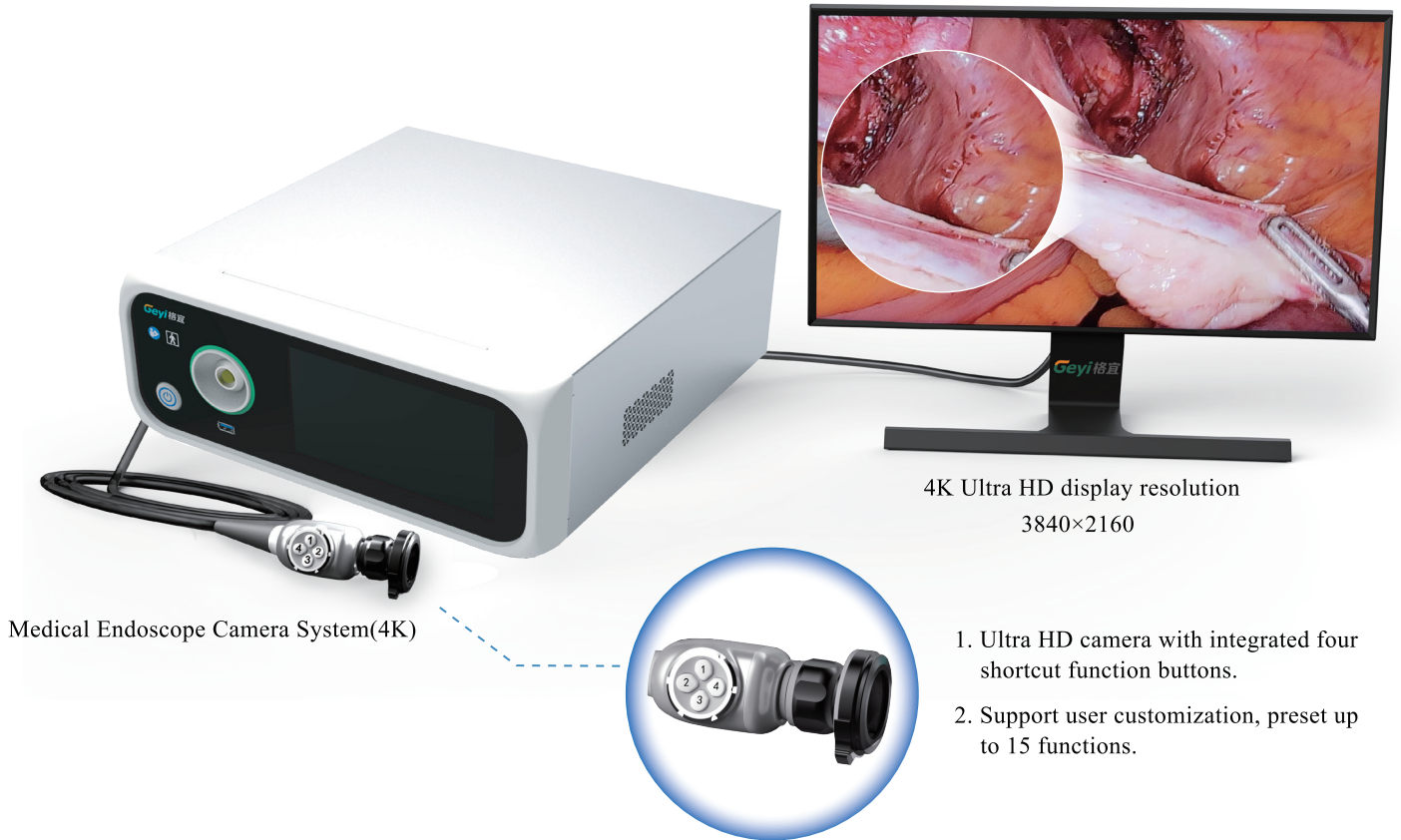

## Product features

1. 1/8 -inch, single-mode 4K ultra-high definition imaging, output pixels  $\geq 8$  million pixels.
2. Depth algorithm fusion, color reproduction comparable to 3CMOS-4K.
3. Horizontal resolution  $\geq 2100$  lines, supporting multiple output frame rates.
4. With 4K and full HD output, compatible with HDMI 2.0, 12G-SDI, DVI video output interface, to meet the simultaneous display of multiple screens.
5. The camera is compatible with fixed focus and zoom optical interfaces, and the adaptability of hard lens is more diverse.
6. It supports the functions of defogging, anti-red overflow and moire removal.

Model	Special functions	Output resolution	Video output	Video input
GY4K-A01	Support one-click de-fog, anti-red overflow	3840*2160 (4K) 1920*1080 (1080P)	HDMI2.0、(12G-SDI) HDMI1.4/DVI/3G-SDI	DVI、3G-SDI
GY4K-B01	Support one-click de-fog, anti-red overflow	3840*2160 (4K) 1920*1080 (1080P)	HDMI2.0、(12G-SDI) HDMI1.4/DVI/3G-SDI	DVI、3G-SDI
GY4K-C01	Support one-click de-fog, anti-red overflow	3840*2160 (4K) 1920*1080 (1080P)	HDMI2.0、(12G-SDI) HDMI1.4/DVI/3G-SDI	DVI、3G-SDI

## 3.2 Medical Endoscope Camera System(Dual Endoscopes)

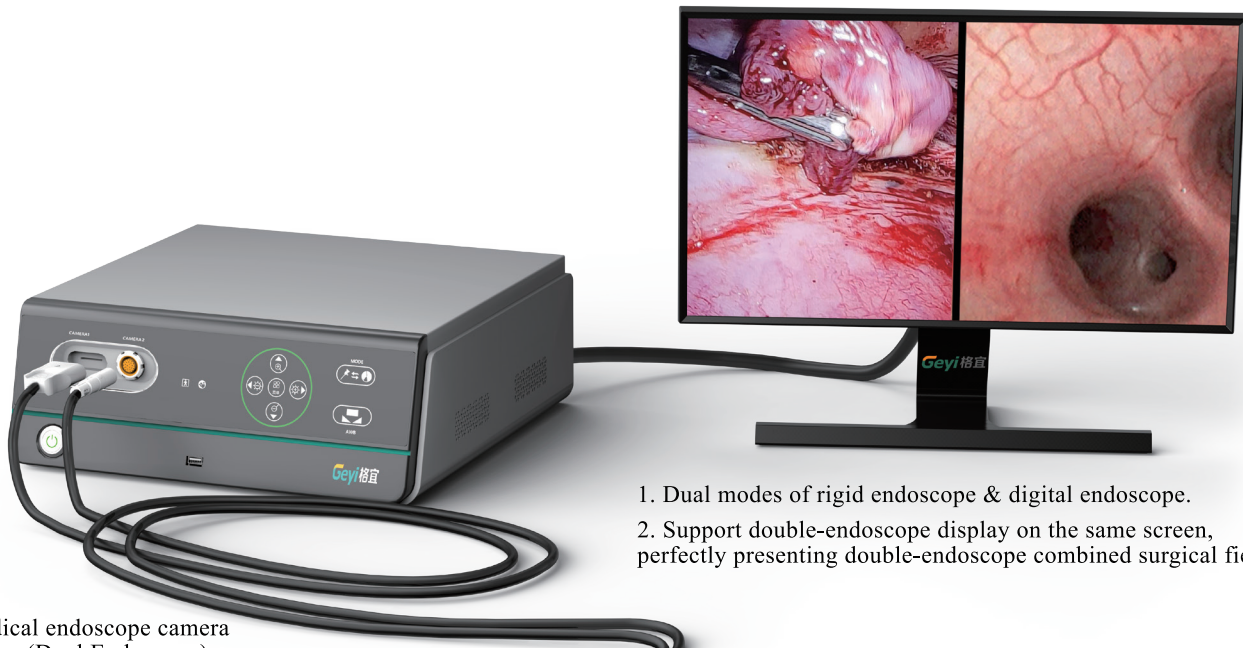

1. Dual modes of rigid endoscope & digital endoscope.
2. Support double-endoscope display on the same screen, perfectly presenting double-endoscope combined surgical field of view.

Medical endoscope camera system(Dual Endoscope)

Compatible With Various Medical Digital Optics and endoscopes

Flexible Ureteroscope



Choledochoscope



Cystoscope



Bronchoscope



Hysteroscope

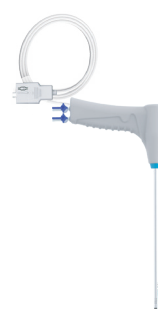

Medical optical camera



### Product features

1. 1/8 -inch full HD imaging, output pixels  $\geq 2$  million pixels.
2. It supports the simultaneous imaging of rigid endoscope and digital endoscope, and the adaptability of departments is more abundant and diverse.
3. Support 3G-SDI, DVI video format input, horizontal resolution  $\geq 1100$  lines.
4. Supports multiple output frame rates: 60p/50p/30p/25p optional.
5. Compatible with HDMI 2.0, 3G-SDI, DVI video output interfaces to meet the needs of multi-display.
6. The camera is compatible with fixed focus and zoom optical interfaces, and the adaptability of hard lens is more diverse.
7. Support moire removal and picture-in-picture function.

Model	Video input	Video output	Output resolution
GYHD-A01	DVI、3G-SDI	HDMI1.4/DVI/3G-SDI	1920*1080 (1080P)

## 3.3 Image Processor



Image Processor

## Compatible With Various Endoscopes

Flexible Ureteroscope



Choledochoscope



Cystoscope



Bronchoscope



Hysteroscope



## Product features

1. Support 3G-SDI, DVI video format input, perfect visualization of the surgical field.
2. Electrostatic induction button, no need to touch, respond when get close.

Model	Video output	Output resolution
GYDE-A01	HDMI1.4/DVI/3G-SDI/CVBS	1920*1080 (1080P)
GYDE-A02	HDMI1.4/DVI/3G-SDI/CVBS	1920*1080 (1080P)

## 3.4 Image Processor (Portable)

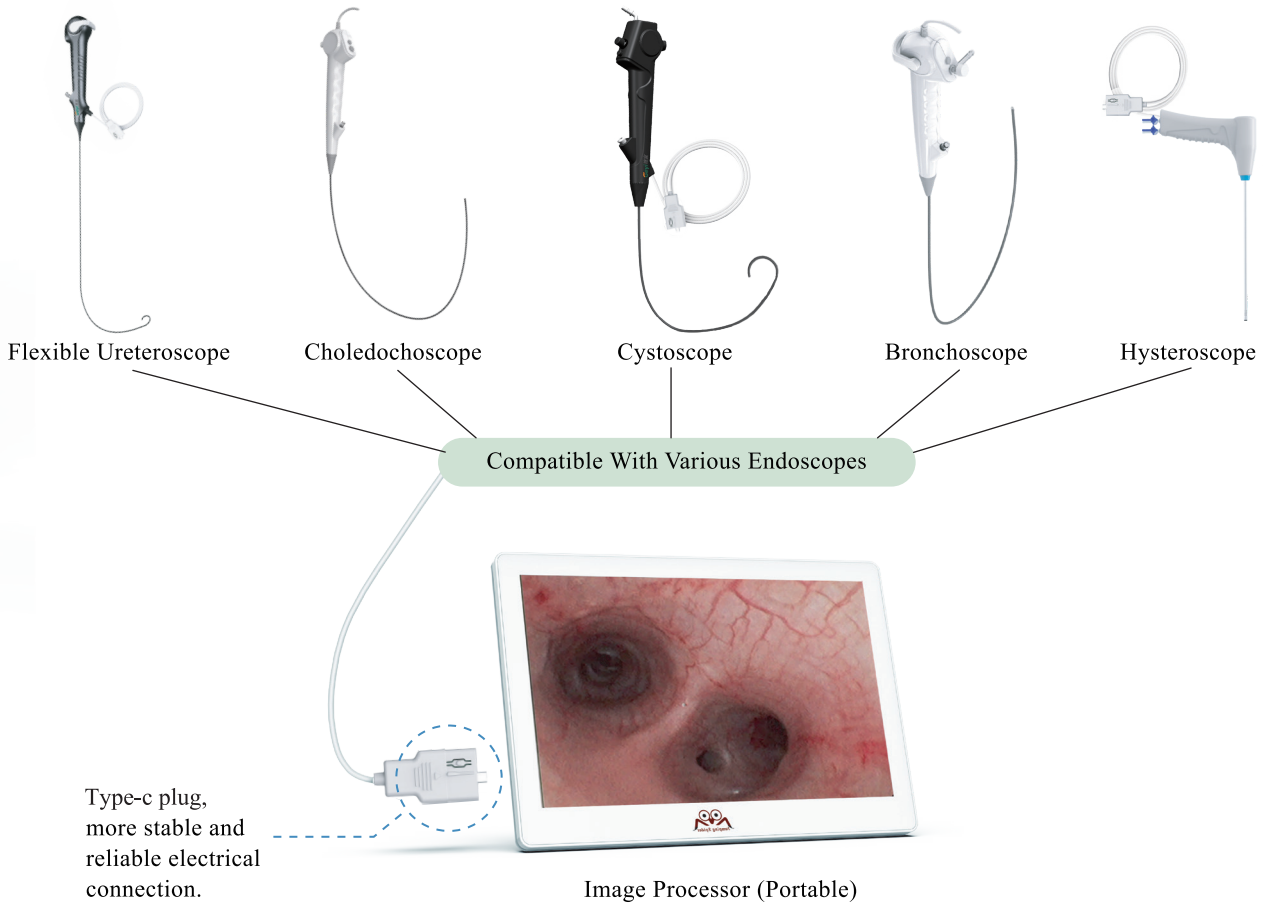

It is small and thin, which is convenient for doctors to diagnose and treat quickly and improve the efficiency of diagnosis and treatment.



Frosted non-slip design, large deployment angle.

## Product features

1. It has a 12.1-inch touch screen display.
2. Display resolution of 1280 × 800 pixels; Extended output resolution: 1920 \* 1080 pixels.
3. Extended output video formats .
4. Portable, lightweight and ultra-thin. Built-in battery, with 8 hours of long battery life.
5. Support USB export, with build-in 32G storage.

Model	Video output	Output resolution
GY - AIO -121	HDMI1.4	1280-800(720P) 1920*1080 (1080P)
GY - AIO -121 (A)	HDMI1.4	1280-800(720P) 1920*1080 (1080P)

## 4.1 Disposable Laparoscopic Monopolar Electrode(Cutting Electrode)

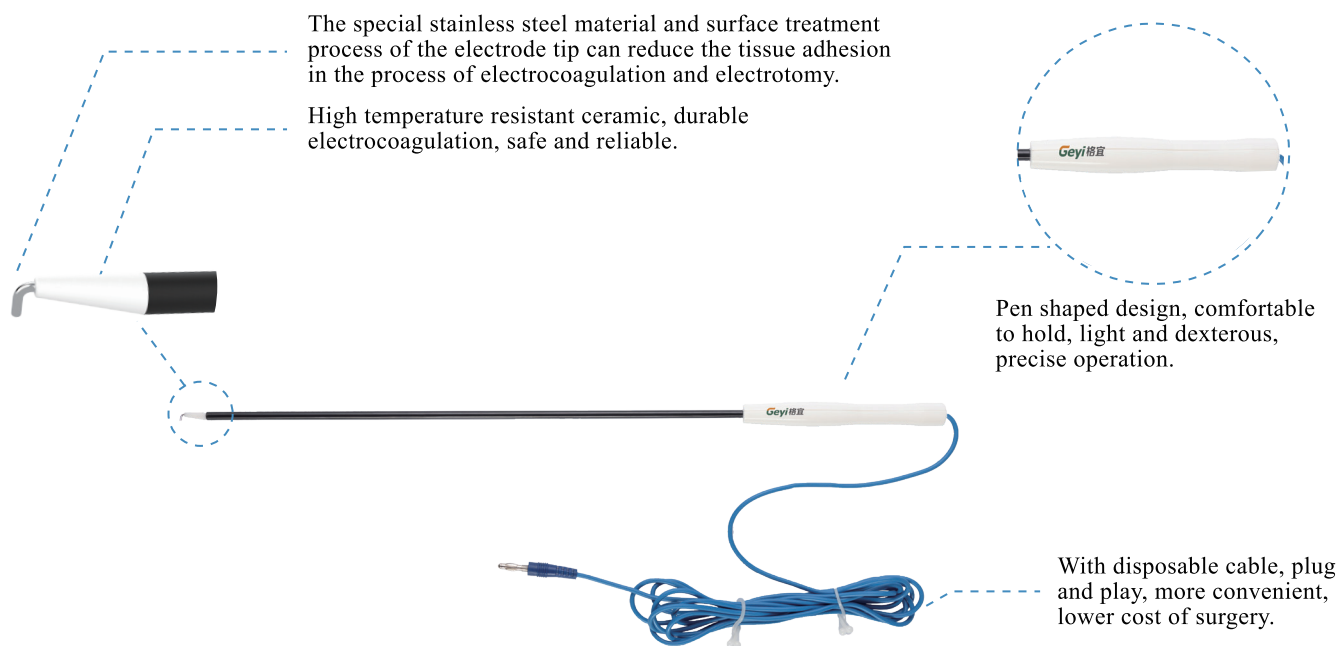

## Product features

1. High temperature resistant ceramic, durable electrocoagulation, safe and reliable.
2. Special stainless steel material and surface treatment process can effectively reduce tissue adhesion.
3. With disposable cable, plug and play, more convenient, lower cost of surgery.
4. Ergonomic handle design, compatible with large and small hands, more comfortable to hold.

Model	Working length(mm)	Electrode head shape	Working diameter(mm)
GYEE-CF01 $\Phi 5 \times 330$	330		$\Phi 5.0$
GYEE-CF01 $\Phi 5 \times 450$	450		
GYEE-CF02 $\Phi 5 \times 330$	330		
GYEE-CF02 $\Phi 5 \times 450$	450		
GYEE-CF03 $\Phi 5 \times 330$	330		
GYEE-CF03 $\Phi 5 \times 450$	450		
GYEE-CF04 $\Phi 5 \times 330$	330		
GYEE-CF04 $\Phi 5 \times 450$	450		
GYEE-CF05 $\Phi 5 \times 330$	330		
GYEE-CF05 $\Phi 5 \times 450$	450		

## 4.2 Disposable Laparoscopic Monopolar Electrode(Dissector)

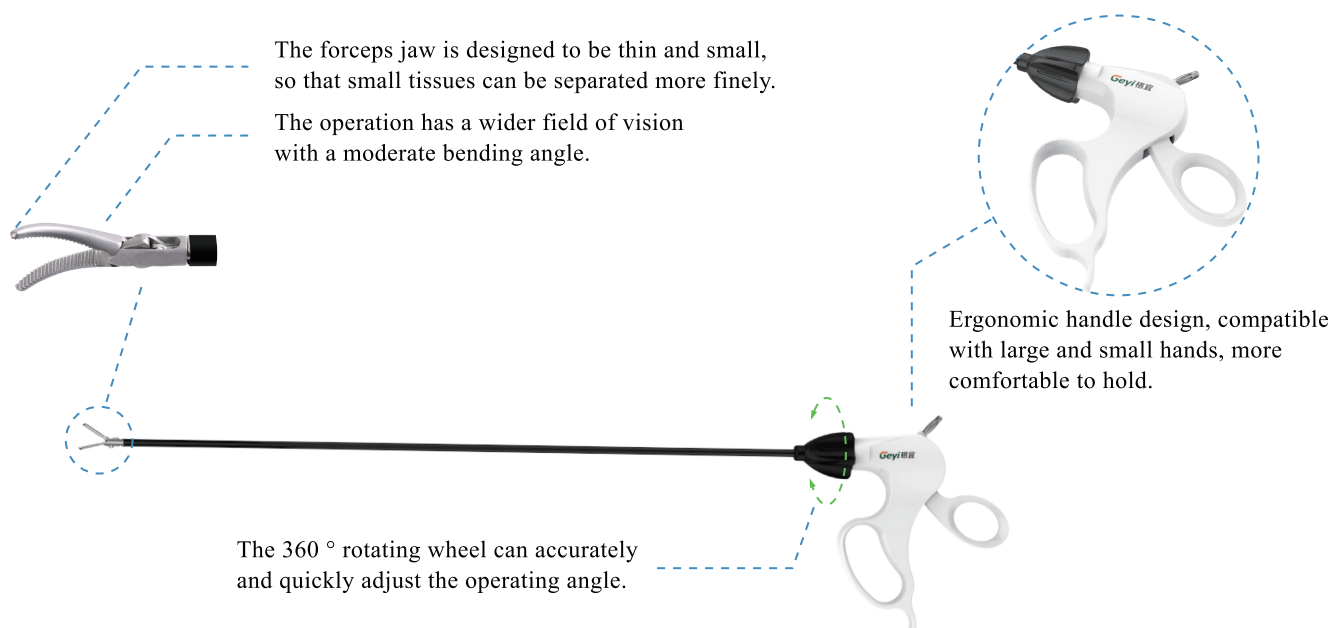

## Product features

1. The operation has a wider field of vision with a moderate bending angle.
2. The forceps jaw is designed to be thin and small, so that small tissues can be separated more finely.
3. The 360 ° rotating wheel can accurately and quickly adjust the operating angle.
4. Ergonomic handle design, compatible with large and small hands, more comfortable to hold.

Model	Working length(mm)	Electrode head shape	Working diameter(mm)
GYEE-DF01 $\Phi 5 \times 330$	330		$\Phi 5.0$
GYEE-DF01 $\Phi 5 \times 450$	450		
GYEE-DF02 $\Phi 5 \times 330$	330		
GYEE-DF02 $\Phi 5 \times 450$	450		
GYEE-DF03 $\Phi 5 \times 330$	330		
GYEE-DF03 $\Phi 5 \times 450$	450		

## 4.3 Disposable Laparoscopic Monopolar Electrode(Grasper)

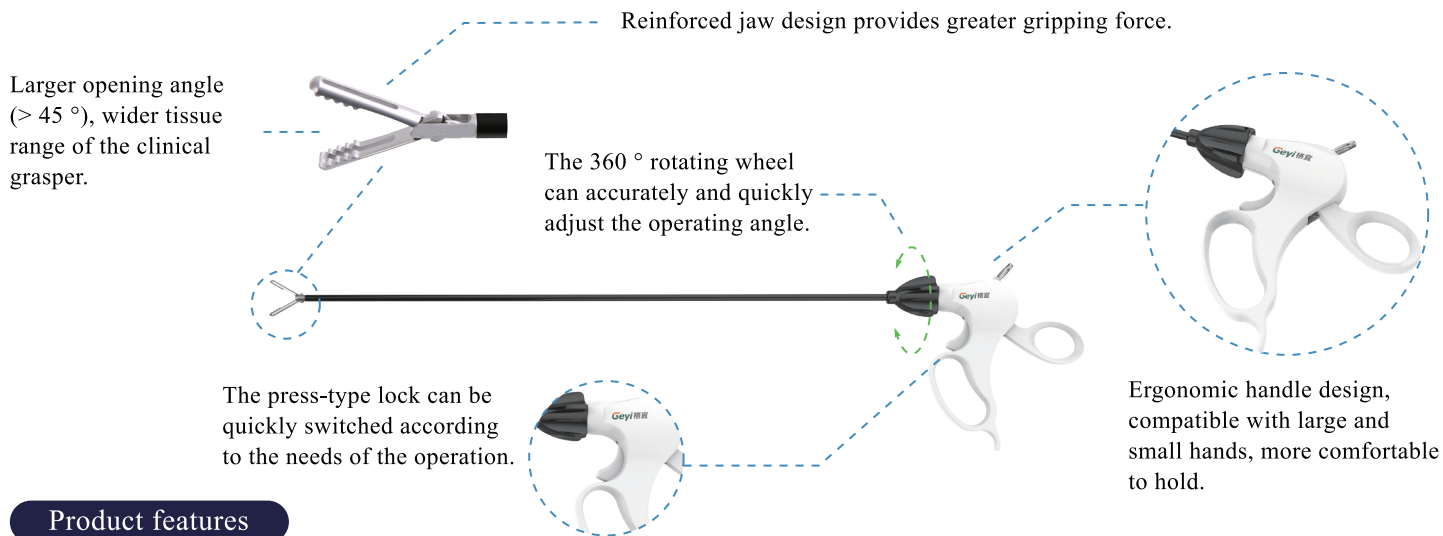

## Product features

1. Reinforced jaw design provides greater gripping force.
2. With a larger opening angle, the tissue range of the clinical grasper is wider.
3. The press-type lock can be quickly switched according to the needs of the operation.
4. The 360 ° rotating wheel can accurately and quickly adjust the operating angle.
5. Ergonomic handle design, compatible with large and small hands, more comfortable to hold.

Model	Working length(mm)	Electrode head shape	Working diameter(mm)
GYEE-FT01 $\Phi 5 \times 330$	330		$\Phi 5.0$
GYEE-FT01 $\Phi 5 \times 450$	450		
GYEE-FT02 $\Phi 5 \times 330$	330		
GYEE-FT02 $\Phi 5 \times 450$	450		
GYEE-FT03 $\Phi 5 \times 330$	330		
GYEE-FT03 $\Phi 5 \times 450$	450		
GYEE-FT04 $\Phi 5 \times 330$	330		
GYEE-FT04 $\Phi 5 \times 450$	450		
GYEE-FT05 $\Phi 5 \times 330$	330		
GYEE-FT05 $\Phi 5 \times 450$	450		
GYEE-FT06 $\Phi 5 \times 330$	330		
GYEE-FT06 $\Phi 5 \times 450$	450		
GYEE-FT07 $\Phi 5 \times 330$	330		
GYEE-FT07 $\Phi 5 \times 450$	450		
GYEE-FT08 $\Phi 5 \times 330$	330		
GYEE-FT08 $\Phi 5 \times 450$	450		
GYEE-FT09 $\Phi 5 \times 330$	330		
GYEE-FT09 $\Phi 5 \times 450$	450		

## 4.4 Disposable Laparoscopic Monopolar Electrode(Scissor)

The scissors jaw is more pointed, which is more conducive to fine operation.

Greater open angle ( $> 40^\circ$ ), greater clinical cutting range.

Fine grinding, sharp blade, better cutting.

Full insulation design, reduce the length of live parts, higher safety.





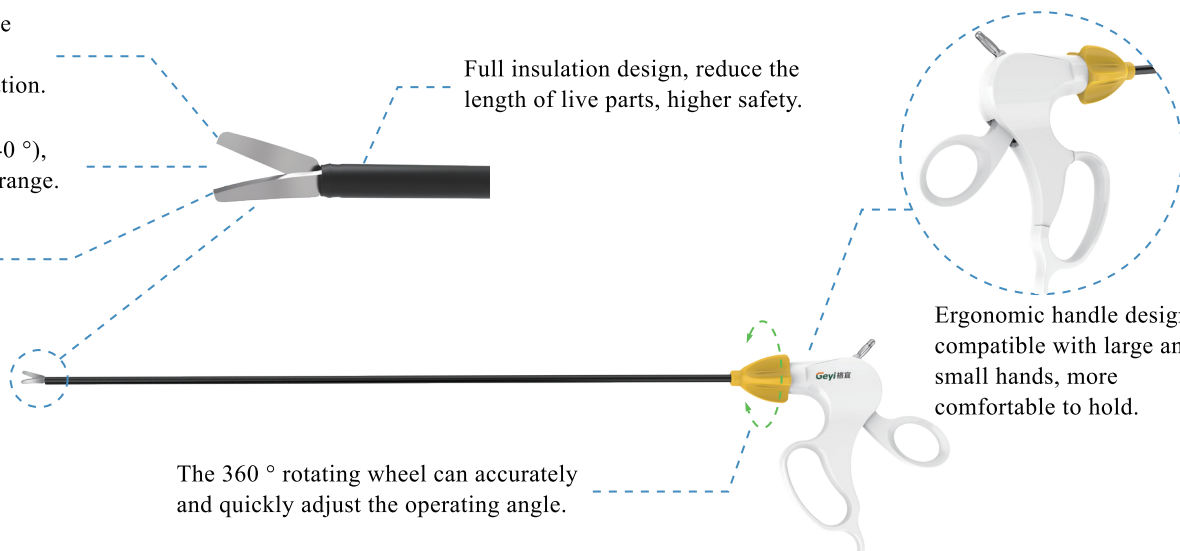



Ergonomic handle design, compatible with large and small hands, more comfortable to hold.

The  $360^\circ$  rotating wheel can accurately and quickly adjust the operating angle.



## Product features

1. Full insulation design, reduce the length of live parts, higher safety.
2. Greater open angle , greater clinical cutting range.
3. The scissors jaw is more pointed, which is more conducive to fine operation.
4. The blade is sharp, easy to cut.
5. Ergonomic handle design, compatible with large and small hands, more comfortable to hold.

Model	Working length(mm)	Electrode head shape	Working diameter(mm)
GYEE-DS01 $\Phi 5 \times 330$	330		Φ5.0
GYEE-DS01 $\Phi 5 \times 450$	450		
GYEE-DS02 $\Phi 5 \times 330$	330		
GYEE-DS02 $\Phi 5 \times 450$	450		
GYEE-DS03 $\Phi 5 \times 330$	330		
GYEE-DS03 $\Phi 5 \times 450$	450		
GYEE-DS04 $\Phi 5 \times 330$	330		
GYEE-DS04 $\Phi 5 \times 450$	450		

## 4.5 Disposable Laparoscopic Bipolar Forceps

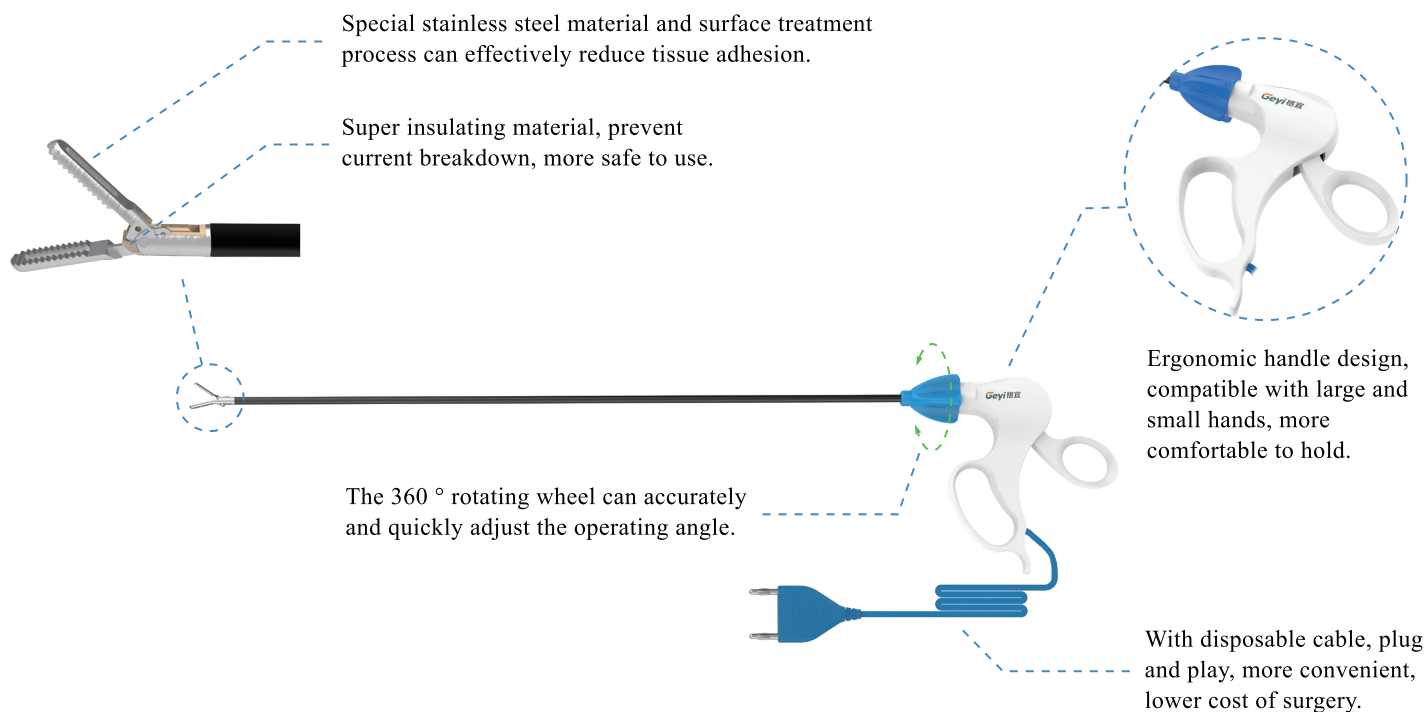

## Product features

1. The special material of forceps jaw can effectively prevent tissue adhesion.
2. Super insulating material, prevent current breakdown, more safe to use.
3. The 360 ° rotating wheel can accurately and quickly adjust the operating angle.
4. Ergonomic handle design, compatible with large and small hands, more comfortable to hold.

Model	Working length(mm)	Electrode head shape	Working diameter(mm)
GYEE-BC01 $\Phi 5 \times 330$	330		$\Phi 5.0$
GYEE-BC01 $\Phi 5 \times 450$	450		
GYEE-BC02 $\Phi 5 \times 330$	330		
GYEE-BC02 $\Phi 5 \times 450$	450		

## 4.6 Disposable Suction Irrigation With Electrode System

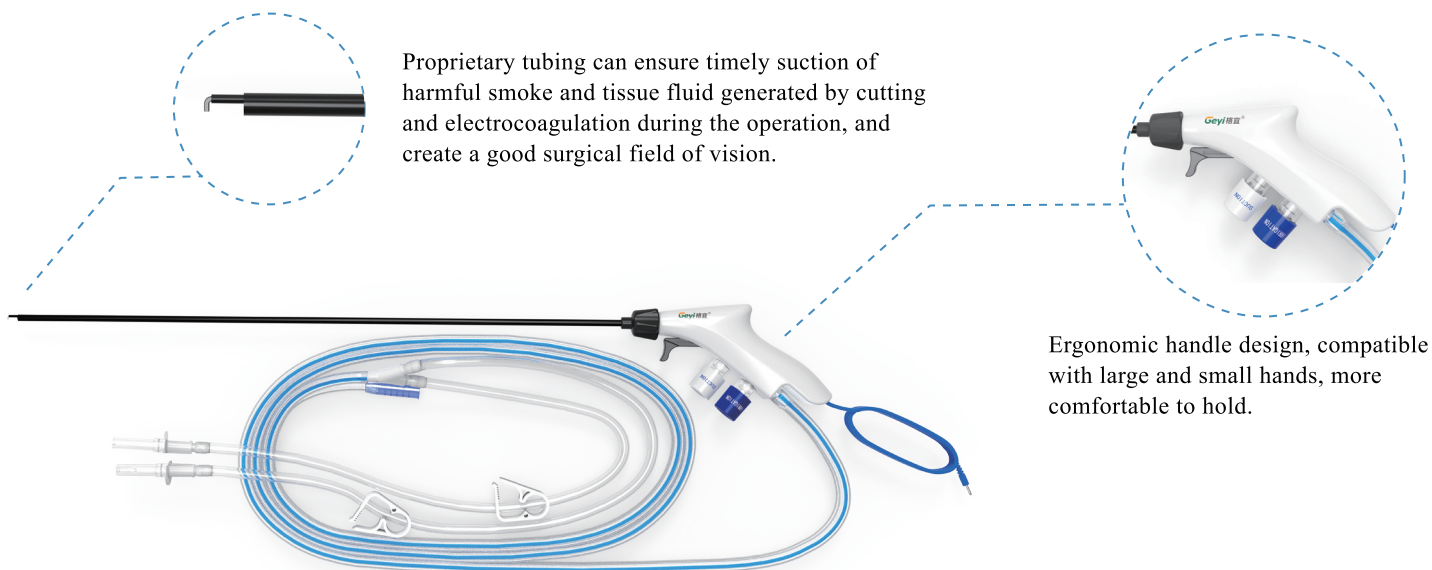











Proprietary tubing can ensure timely suction of harmful smoke and tissue fluid generated by cutting and electrocoagulation during the operation, and create a good surgical field of vision.

Ergonomic handle design, compatible with large and small hands, more comfortable to hold.

## Product features

1. Continuous negative pressure smoking was used during the operation, and the smoke in the process of electrocoagulation/electrotomy was discharged out of the cavity in time to keep the operation vision clear.
2. The rotating wheel which can rotate 360 degrees can be turned to make the forceps jaw reach to any angle required during the operation.
3. Ergonomic handle design, compatible with large and small hands, more comfortable to hold.

Model	Working length(mm)	Electrode head shape	Working diameter(mm)
GYXR-F5×330GZ	330		Φ5.0
GYXR-F5×450GZ	450		
GYXR-F5×330BZ	330		
GYXR-F5×450BZ	450		
GYXR-F5×330CZ	330		
GYXR-F5×450CZ	450		
GYXR-F5×330DZ	330		
GYXR-F5×450DZ	450		
GYXR-F5×330ZZ	330		
GYXR-F5×450ZZ	450		

## 5.1 Disposable Circumcision Staplers



## Product features

1. The overall forming of the anvil to ensure that the staples forming integrity.
2. Special structure of the mat ring, effectively prompted the cutting suture to complete.
3. The combination of the ring knife and the push piece ensures the integrity of the cutting suture.
4. Anti-skid design of ergonomics. More comfortable to handle.

Model	Diameter of Circular Knife(mm)	Staple Quantity	Nail type	Type
GYCD-11D	Φ11	9	Thin nail	Type D
GYCD-15D	Φ15	11		
GYCD-19D	Φ19	14		
GYCD-21D	Φ21	15		
GYCD-25D	Φ25	18		
GYCD-29D	Φ29	20		
GYCD-31D	Φ31	21		
GYCD-13F	Φ13	10	Wide nail	Type F
GYCD-15F	Φ15	11		
GYCD-17F	Φ16.5	12		
GYCD-21F	Φ21	15		
GYCD-25F	Φ25	18		
GYCD-29F	Φ29	20		
GYCD-32F	Φ32	22		
GYCD-34F	Φ34	24		

## 5.2 Disposable Linear Cutter Staplers



Type A



Type B

## Product features

## Type A

1. Camshaft design, effective avoid the risk of pushing and twisting forward during transportation.
2. Stainless steel position buckle, ensures the stability of stapler during cutting and suturing.
3. Cartridge with an anti second fire design, avoid accidental firing of an empty cartridge.

## Type B

1. Unique firing button, suitable for both hands.
2. Integrated design of blade and cartridge, provides a neat cutting performance.
3. Anti-skid design in handle, comfortable to fire.
4. Cartridge with an anti second fire design, avoid accidental firing of an empty cartridge.

Model	Component Model	Suture Length(mm)	Staple Height(mm)	Staple Quantity
GYCW-(B)55L	GYCZ-(A/B)55L	55	3.85	56
GYCW-(B)55H	GYCZ-(A/B)55H	55	4.5	
GYCW-(A)60L	GYCZ-(A/B)60L	63	3.85	64
GYCW-(A)60H	GYCZ-(A/B)60H	63	4.5	
GYCW-(B)75L	GYCZ-(A/B)75L	75	3.85	76
GYCW-(B)75H	GYCZ-(A/B)75H	75	4.5	
GYCW-(A)80L	GYCZ-(A/B)80L	83	3.85	84
GYCW-(A)80H	GYCZ-(A/B)80H	83	4.5	
GYCW-(B)100L	GYCZ-(B)100L	100	3.85	100
GYCW-(B)100H	GYCZ-(B)100H	100	4.5	
GYCW-(A)100L	GYCZ-(A)100L	103	3.85	104
GYCW-(A)100H	GYCZ-(A)100H	103	4.5	

### 5.3 Disposable Linear Cutter for Endoscope Use

#### Product features

1. Components can be rotated 45 degree left and right,flexible to reach different surgical site.
2. The small span between the trigger and handle increases the fires of comfort and reduces the firing strength.
3. The tactile feedback when firing,allows the surgeon to confirm that suture staple has shaped.
4. Instrument can be rotated 360 degree, which makes the equipment can be used in any place.
5. Intuitive and simple handle design makes the doctor be clear at a glance, easy to operate.



Model	Rod length(mm)	Component Model	Staple Height(mm)	Suture Length(mm)	Staple Quantity	
GYRC-85	85	GYRCZ-(B/C)30(V/L/H/M)	Type B V: 2.0 L: 2.5 H: 3.5 M: 4.5	31	48	
		GYRCZ-(B/C)45(V/L/H/M)		43	66	
		GYRCZ-(B/C)60(V/L/H/M)		59	90	
GYRC-100	100	GYRCZ-(B/C)30(V/L/H/M)		31	48	
		GYRCZ-(B/C)45(V/L/H/M)		43	66	
		GYRCZ-(B/C)60(V/L/H/M)		59	90	
GYRC-160	160	GYRCZ-(B/C)30(V/L/H/M)		Type C V: 2.0 2.5 3.0 L: 2.5 2.5 3.0 H: 3.0 3.5 4.0 M: 4.0 4.5 5.0	31	48
		GYRCZ-(B/C)45(V/L/H/M)			43	66
		GYRCZ-(B/C)60(V/L/H/M)			59	90
GYRC-260	260	GYRCZ-(B/C)30(V/L/H/M)	31		48	
		GYRCZ-(B/C)45(V/L/H/M)	43		66	
		GYRCZ-(B/C)60(V/L/H/M)	59		90	

### 5.4 Disposable Linear Staplers

#### Product features

1. Staples with different suture lengths and heights, easy to select from different length and thickness of tissue.
2. Parallel closure,uniform pressure on the tissue. One step forming anvil, ensures a perfect B shaped staple.
3. Manual retaining pin, prevents tissue overflow and ensures the suture length.
4. Three stage in single handle design,best for single hand operation.

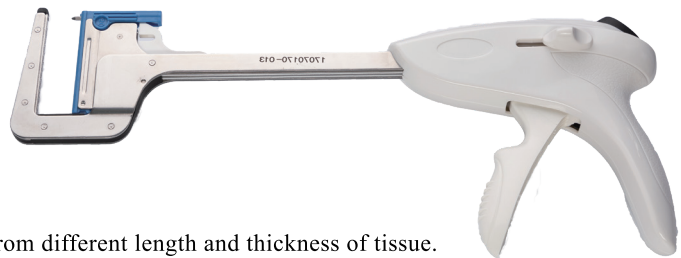

Model	Staple Height(mm)	Staple Quantity	Suture Length(mm)
GYLS-B30(L)	3.8	11	35
GYLS-B30(H)	4.8		
GYLS-B45(L)	3.8	15	46
GYLS-B45(H)	4.8		
GYLS-B60(L)	3.8	21	62.5
GYLS-B60(H)	4.8		
GYLS-B90(L)	3.8	33	95.5
GYLS-B90(H)	4.8		

## 5.5 Disposable Circular Staplers for Hemorrhoids



## Product features

1. More staples, more effective for stopping bleeding.
2. Frosted nut with wing and the adjustment function, avoid slipping and feeling is more perfect.
3. Using new scientific material making the reminder sound more clearly so that the operation is secure.
4. Equipment by surface treatment, moderate intensity, not glare because of reflection.

Model	External diameter(mm)	Annular cutter diameter(mm)	The number of nails	Description	High nail(mm)
GYHS-32	32	23	32	Suitable for PPH surgery	4.2
GYHS-34	34	24	34		
GYHS-32T	32	23	32	Suitable for TST surgery	
GYHS-34T	34	24	34		

## 5.6 Disposable Circular Staplers



## Product features

1. Different diameter and staple height fit for different tissue length and thickness.
2. The variable speed knob,gives tissue a better protection. Press the tissue slowly.
3. The enlarged indicator, ensures a more accurate staple height, easy to operate.

Model	Staple Height(mm)	Outside diameter of nailing bin(mm)	Diameter of cutting tool(mm)	Staple Quantity
GYCS-B23L	4.6	Φ24	Φ15	18
GYCS-B23H	5.0			
GYCS-B25L	4.6	Φ26	Φ17	20
GYCS-B25H	5.0			
GYCS-B29L	4.6	Φ29	Φ20	24
GYCS-B29H	5.0			
GYCS-B32H	5.0	Φ32	Φ22	30
GYCS-B34H	5.0	Φ34	Φ24	32

## 6.1 Disposable Suction &amp; Irrigation Sets

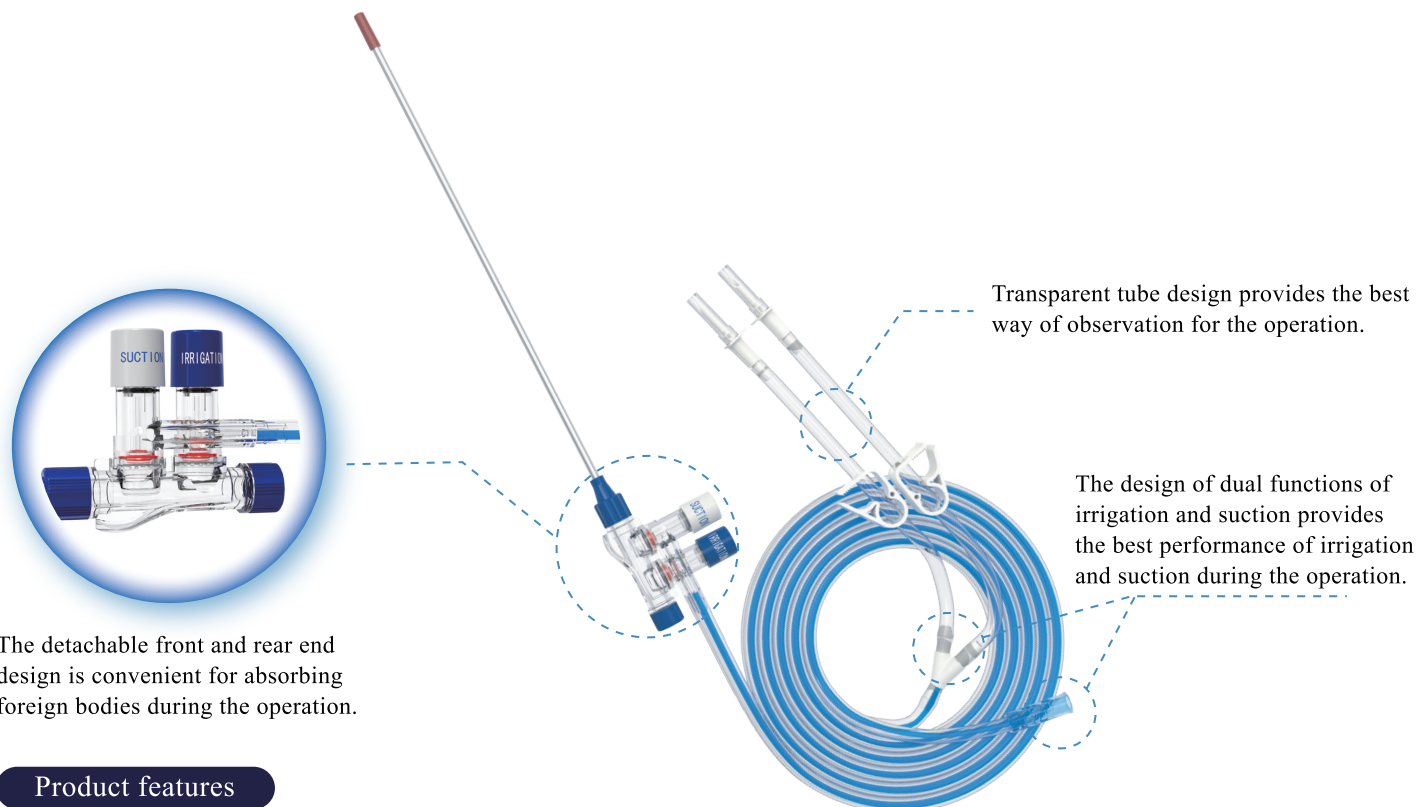

The detachable front and rear end design is convenient for absorbing foreign bodies during the operation.

## Product features

1. The multi-holes in probe ensures smooth suction.
2. Soft PVC pipe, suction pipe to avoid entanglement.
3. Process rounding reduces the risk of tissue damage during blunt dissection.
4. Slim stainless steel probe, provides a variety of diameter and length specifications can be selected.
5. Lightweight handpiece design, allows one hand to easily complete suction and irrigation, excellent control.

Model	Working length(mm)	Working diameter(mm)
GYSL-3×280	280	Φ3
GYSL-3×330	330	
GYSL-5×280	280	Φ5
GYSL-5×330	330	
GYSL-5×450	450	
GYSL-10×280	280	Φ10
GYSL-10×330	330	
GYSL-10×450	450	

## 6.2 Disposable Specimen Retrieval Bag

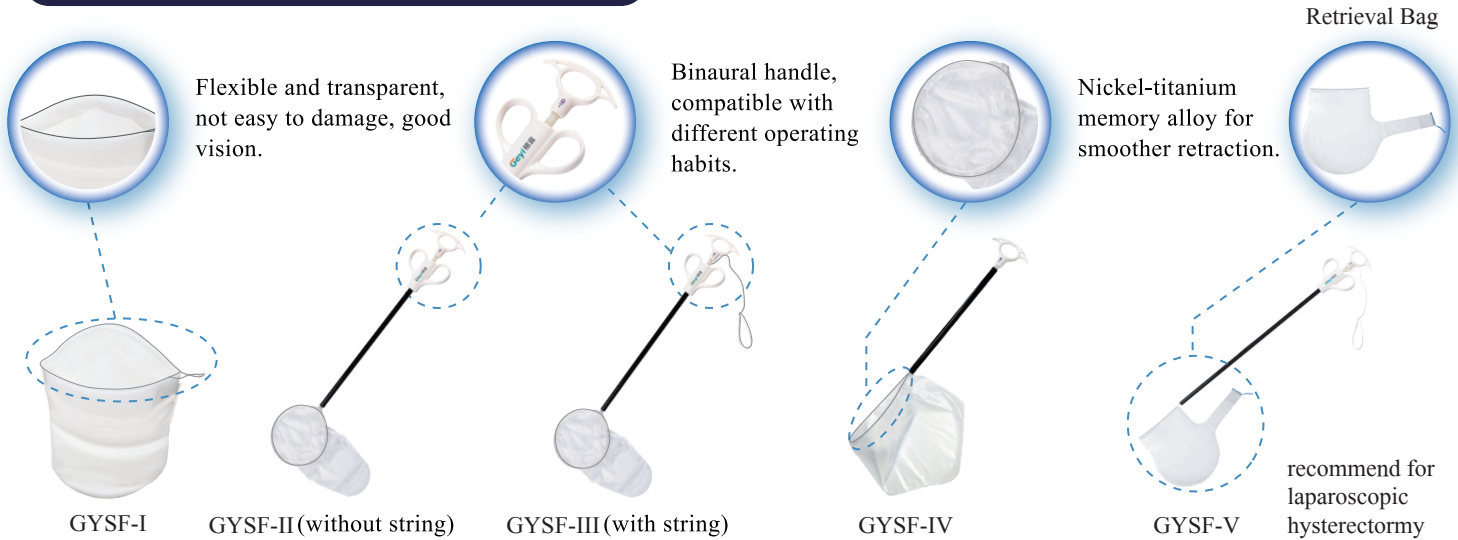

## Product features

1. The bag is transparent and soft, and adopts high-strength TPU material with good biocompatibility.
2. The opening device is made of medical memory alloy material, and the bag is fully opened to facilitate the insertion of specimens.
3. Automatically tighten the bag when removing to avoid inflammation caused by tumor implantation or tissue fluid penetration, reducing the risk of tissue damage.
4. Simple, safe and effective. There are various specifications of bags to choose from to meet different surgical needs.

Model	Volume(ml)	Model	Volume(ml)	Model	Volume(ml)
GYSF- I 35	35ml	GYSF- III 50	50ml	GYSF- V 1000-12	1000ml
GYSF- I 80	80ml	GYSF- III 100	100ml	GYSF- V 600-15	600ml
GYSF- I 130	130ml	GYSF- III 150	150ml	GYSF- V 1200-15	1200ml
GYSF- I 200	200ml	GYSF- III 250	250ml	GYSF- V 2000-15	2000ml
GYSF- I 300	300ml	GYSF- III 300	300ml	GYSF- V 1200-20	1200ml
GYSF- II 50	50ml	GYSF- IV 50	50ml	GYSF- V 2000-20	2000ml
GYSF- II 100	100ml	GYSF- IV 100	100ml		
GYSF- II 150	150ml	GYSF- IV 150	150ml		
GYSF- II 250	250ml	GYSF- IV 250	250ml		
GYSF- II 300	300ml	GYSF- IV 300	300ml		

## 6.3 Disposable Veress Needle

## Product features

1. The veress needle is made of medical 304 stainless steel with excellent performance.
2. The head of the ventilation core is rounded to avoid tissue damage.



A pneumoperitoneum needle is used to establish pneumoperitoneum in advance, and then a puncture needle is used to puncture, so as to prevent the tip of the puncture needle from damaging the internal tissues in the absence of pneumoperitoneum.

Model	Cannula length	Trocar diameter(mm)
GYVN-A100	100	Φ2.1
GYVN-A120	120	
GYVN-A150	150	

## 6.4 Disposable Automatic Clip Applier

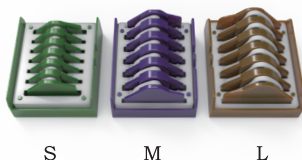
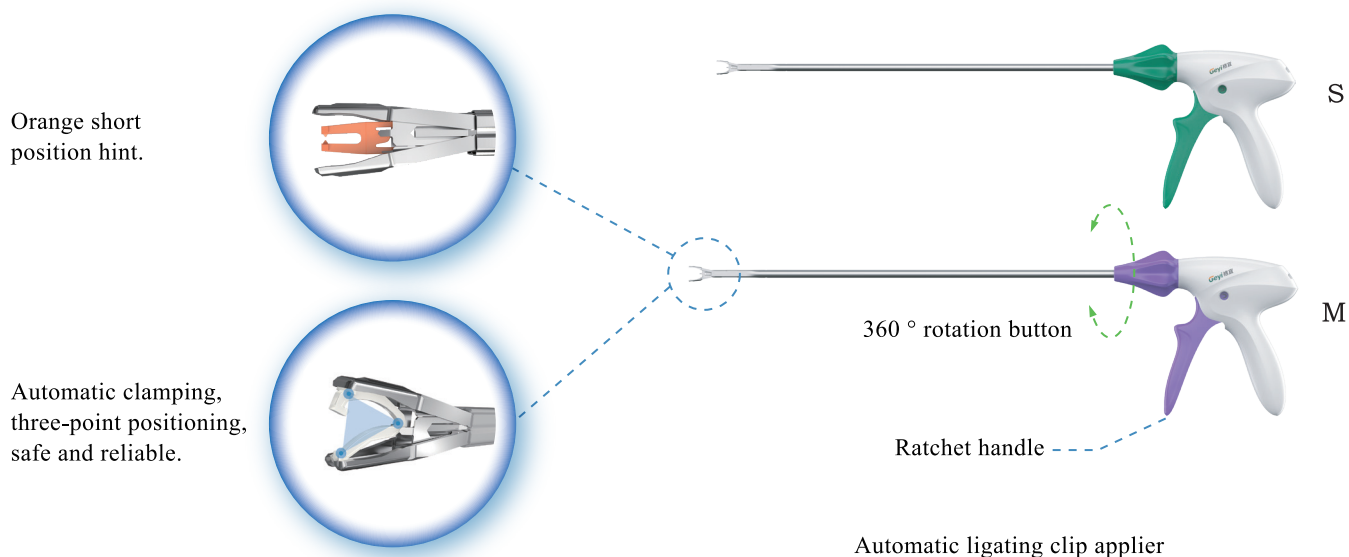

The matching single ligating clip can be matched with the clip applier to meet different clinical requirements.

## Product features

1. The novel continuously firing design can efficiently and continuously ligate the parts that need to be ligated.
2. Adopt high molecular polymer clip with good biocompatibility, unique anti-slip, anti-drop clip design, transparent and no artifacts.
3. Various specifications and models to meet the needs of different clinical operations.
4. Single use to avoid cross infection.

Model			Working diameter(mm)	Working length(mm)
GYLC-SA-03	GYLC-SA-06	GYLC-SA-08	Φ5.5	297
GYLC-SA-10	GYLC-SA-12	GYLC-SA-15		
GYLC-MA-03	GYLC-MA-06	GYLC-MA-08	Φ10.5	
GYLC-MA-10	GYLC-MA-12	GYLC-MA-15		

Eg: GYLC-SA-06, S: Clip size , A: Disposable clip applier, 06: Clips/cartridge quantity

## 6.5 Ligating Clips

S

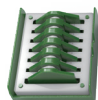

M



L

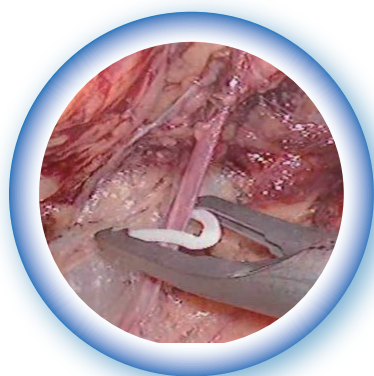

Examples

## Safety lock

1. 360 ° all-round ligation, safe and reliable lock.
2. Clear hand feeling when the clip is closed, and safety information is transmitted.

## Limiting bulge

1. Precise upper clip, not easy to drop.
2. Accurate guidance and efficient ligation.

## Anti-slip design

1. Arc anti-slip surface, more consistent with the blood vessel interface.
2. Integrated anti-slip teeth to effectively prevent sliding.

## Arc design

1. Arc design, larger ligation range.
2. Even stress, no cutting effect.

## Elastic connection

1. Adjust the elasticity according to the force.
2. Once ligation failed, clear bounce.

## Product features

1. Protruding design keeps the clip firmly on the applicator.
2. Integral tooth structure to integrate with blood vessels.
3. Buckle locking mechanism provides tactile feedback to make sure closure.
4. Arcuate structure, closure clips can be removed with appropriate instruments.
5. Hinge structure, flexible release, clearly pops off if ligation fails.
6. Non-absorbable polymer material, inert, non-conductive, radiolucent, does not affect CT, MRI, X-ray diagnosis.

Model				Specification
GYCP-S01	GYCP-S02	GYCP-S03	GYCP-S04	S
GYCP-S05	GYCP-S06	GYCP-S07	GYCP-S08	
GYCP-M01	GYCP-M02	GYCP-M03	GYCP-M04	M
GYCP-M05	GYCP-M06	GYCP-M07	GYCP-M08	
GYCP-L01	GYCP-L02	GYCP-L03	GYCP-L04	L
GYCP-L05	GYCP-L06	GYCP-L07	GYCP-L08	

Eg: GYCP-S01,01: Clips/cartridge quantity



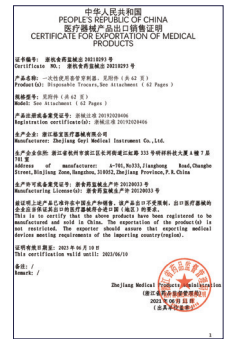



Zhejiang Geyi Medical Instrument Co., Ltd

Factory Address: No. 5, Hutang Road, Xiayai Town,  
Jiande City, Zhejiang Province

Office Address: No. 5, Hutang Road, Xiayai Town,  
Jiande City, Zhejiang Province

Tel: 0086 571 86676309

Web: [www.geyi-medical.com](http://www.geyi-medical.com)

E-mail: [info@geyi-medical.com](mailto:info@geyi-medical.com)

Postcode: 310051



Official website.